



67 Moyle Road, Ballycastle, BT54 6LG

Offers Over £199,950



3



1



1



F38 / D64

Nestled on the charming Moyle Road in Ballycastle, this delightful semi-detached bungalow offers a perfect blend of comfort and convenience. Spanning an impressive 1,065 square feet, this traditional block built property features a well-designed layout that is ideal for families or those seeking a peaceful retreat.

The bungalow boasts a welcoming reception room, providing a warm and inviting space for relaxation and entertaining. With three spacious bedrooms, there is ample room for family members or guests, ensuring everyone has their own private sanctuary. The bathroom is thoughtfully appointed, catering to the needs of modern living.

Constructed in 1983, this property retains a sense of character while offering the potential for personalisation to suit your taste. The exterior is complemented by parking space for up to three vehicles, a valuable asset in this desirable area.

Situated in Ballycastle, residents can enjoy the stunning natural beauty of the surrounding landscape, with nearby beaches and scenic walks just a stone's throw away. The local community is vibrant, with a range of amenities, shops, and eateries within easy reach.

This bungalow presents an excellent opportunity for those looking to settle in a tranquil yet accessible location. Whether you are a first-time buyer, a growing family, or seeking a retirement haven, this property is sure to meet your needs. Do not miss the chance to make this charming bungalow your new home.

- Semi-Detached Bungalow
- 1 x Reception Room
- Convenient To The Beach/Sea Front
- Ideal Holiday Home
- uPVC Double Glazed Windows
- 3 x Bedroom
- Integrated Garage
- Perfect Retirement or First Time Buyer Property
- Oil Fired Heating
- PVC Fascia & Soffits

For all photos and details, please go to www.amgproperty.com

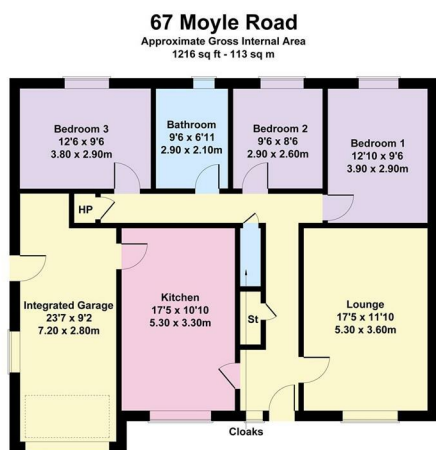

Not to Scale. Produced by The Plan Portal 2025
For Illustrative Purposes Only.

