



33 Tamlough Road

Randalstown, Antrim, BT41 3DP

Offers Around £349,950



33 Tamlough Road

Randalstown, Antrim, BT41 3DP

Offers Around £349,950



GROUND FLOOR

Hallway

16'5" x 6'2" (5.02 x 1.89)

Tiled flooring.

Lounge

14'8" x 12'8" (4.48 x 3.87)

Multi fuel stove. Coving and ceiling rose. Solid wood flooring.

Kitchen / Family Dining

14'7" x 12'8" (4.45 x 3.88)

Refitted kitchen with high and low level units with L:ED kickboard lighting. Halogens hob with stainless steel extractor hood. Electric oven. Space for fridge / freezer. 1 1/2 bowl; stainless steel sink. Integrated dishwasher. Central island with casual dining overhang.

Utility Room

6'1" x 7'9" (1.87 x 2.37)

High and low level units. Stainless steel sink. Plumbed for washing machine and space for tumble dryer. Back door. Tiled flooring.

Cloakroom

2'6" x 6'2" (0.78 x 1.88)

LFWC and WHB. Tiled flooring.

Corridor

Large hotpress cupboard.

Family Bathroom

8'4" x 7'8" (2.55 x 2.34)

Refitted suite with LFWC and WHB. Large low access shower unit. Towel radiator. Panelled walls.

Home office / study

9'10" x 8'5" (3.0 x 2.58)

Fitted desk. Laminate flooring.

Dining Room / Bedroom 4 - Front

10'8" x 10'0" (3.27 x 3.07)

Currently used as a formal dining room. but ideal bedroom 4.

Bedroom 1 - Rear

10'8" x 10'4" (3.27 x 3.17)

Double recessed cupboard.

FIRST FLOOR

Landing

Bedroom 2 - Side

19'8" x 13'6" (6 x 4.12)

Fitted robes. Eave storage.

En-suite Shower Room

LFWC and WHB. Quadrant shower. Chrome towel radiator. Fully tiled.

Bedroom 3 - Side

13'4" x 13'6" (4.08 x 4.12)

Fitted robes. Eave storage.

En-suite Shower Room

13'4" x 13'6" (4.08 x 4.12)

Shower cubicle. LFWC and WHB. Fully tiled.

OUTSIDE

Parking and Yardage

Hardstanding parking and yardage to front and rear.

Tel: 02825655733

Flood Lit Sand Arena

Flood lit sand paddock/arena. Grassed cool off arena.

Stable 1

Concrete and matted flooring. Power and water.

Stable 2

Concrete and matted flooring. Power and water.

Log Store / Store Room

Timber Tack Room

Insulated timber tack room.

Agricultural Field

Circa 1.25no. acres of field under grass and in good heart. Livestock fenced and watered.



Road Map



Hybrid Map



Terrain Map



Floor Plan

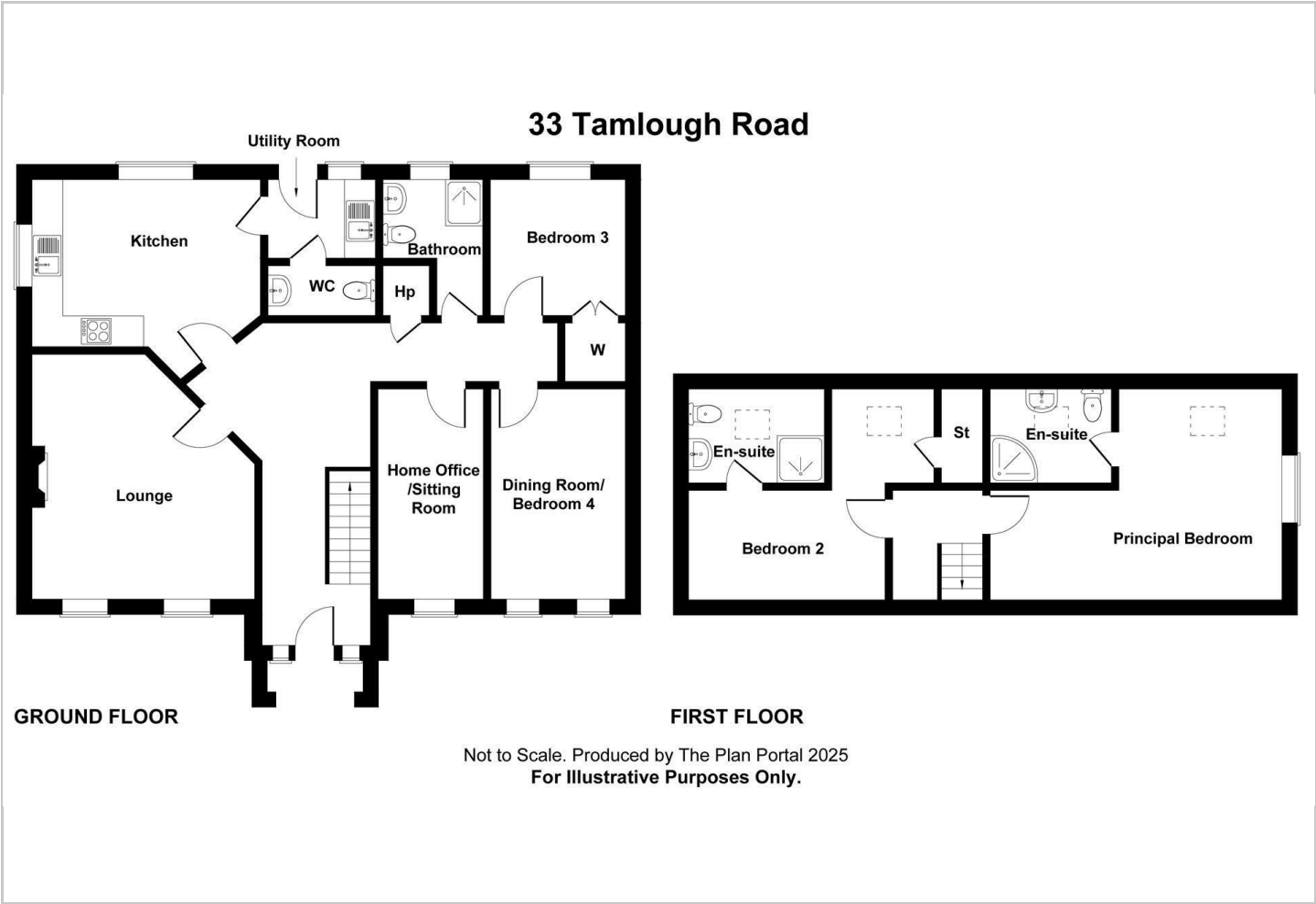

Viewing

Please contact our Ballymena Office on 02825655733 if you wish to arrange a viewing appointment for this property or require further information.

Energy Efficiency Graph



These particulars, whilst believed to be accurate are set out as a general outline only for guidance and do not constitute any part of an offer or contract. Intending purchasers should not rely on them as statements of representation of fact, but must satisfy themselves by inspection or otherwise as to their accuracy. No person in this firms employment has the authority to make or give any representation or warranty in respect of the property. Edmondson Estates have not tested any services, equipment, or facilities within the premises and will not be liable, in negligence or otherwise, for any loss arising from the use of these particulars.