



7 Springmount Mews

Clough, Ballymena, BT44 9FE

Offers Around £99,950



7 Springmount Mews

Clough, Ballymena, BT44 9FE

Offers Around £99,950



ACCOMMODATION

Off street parking

GROUND FLOOR

COMMUNAL ENTRANCE HALL

Hardwood double glazed front door. Stairwell to upper floors.

FIRST FLOOR

ENTRANCE HALL

Hardwood entrance door. Wood laminate floor covering.

BEDROOM 1

12'4 x 11'9 (3.76m x 3.58m)

Wall to wall fitted wardrobes.

BEDROOM 2

12'4 x 10'4 (3.76m x 3.15m)

Wood laminate floor covering. Wall to wall fitted wardrobes.

OPEN PLAN KITCHEN/LIVING/DINING AREA

26'2 x 18'2 (7.98m x 5.54m)

widest points. Modern fitted shaker style kitchen with high and low level storage units and work surfaces. Integrated appliances to include fridge freezer, 4 ring electric hob and oven with stainless steel extractor canopy over. Space for washing machine. Stainless steel sink. Gas fired central heating boiler (housed). Access to store. Wood laminate floor covering.

FAMILY BATHROOM

Modern fitted three piece suite comprising panelled bath, wash hand basin and WC. Wood laminate floor covering. Part tiled walls.

EXTERNAL

Tel: 02825655733



Road Map



Hybrid Map



Terrain Map



Floor Plan

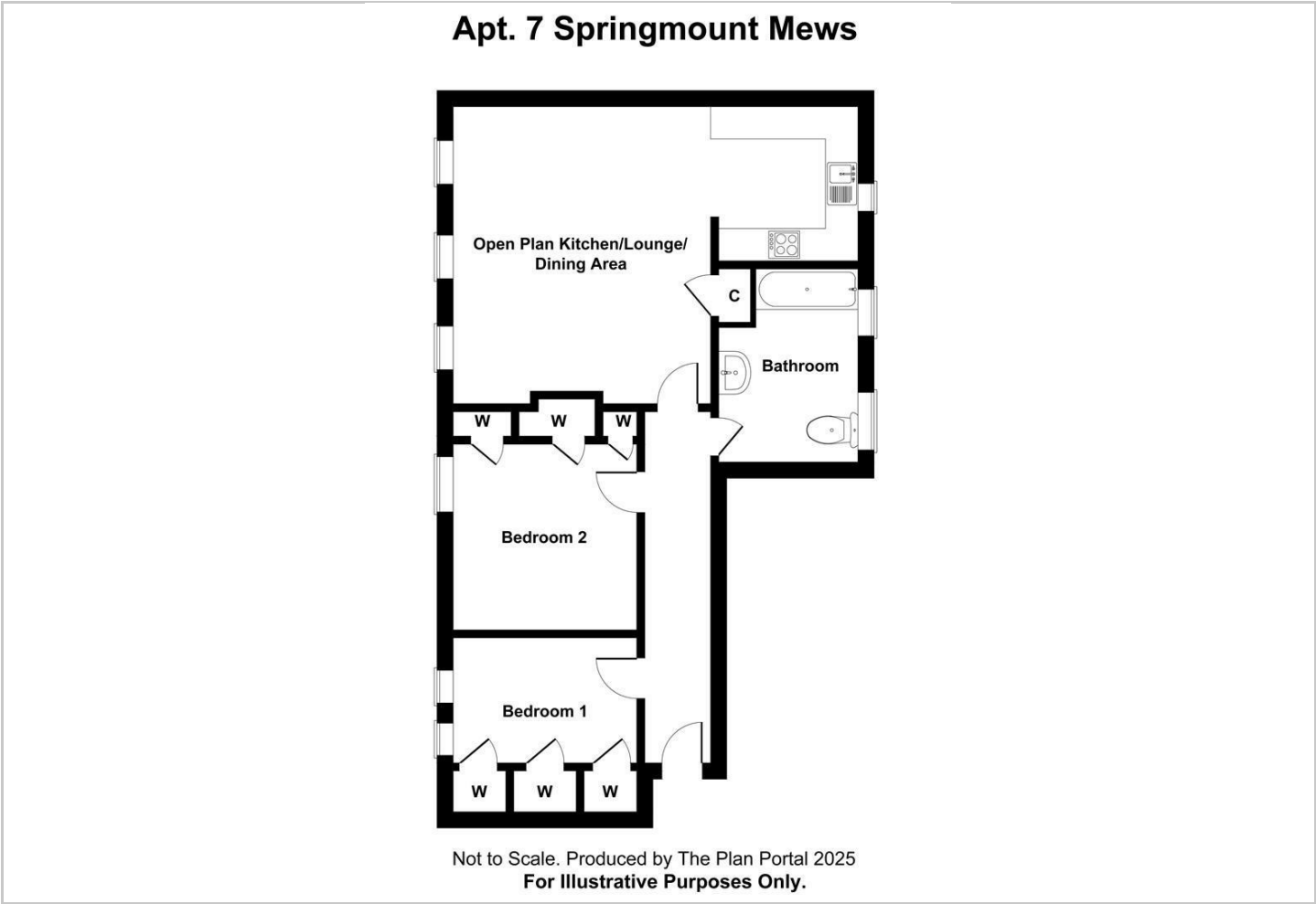

Viewing

Please contact our Ballymena Office on 02825655733 if you wish to arrange a viewing appointment for this property or require further information.

Energy Efficiency Graph



These particulars, whilst believed to be accurate are set out as a general outline only for guidance and do not constitute any part of an offer or contract. Intending purchasers should not rely on them as statements of representation of fact, but must satisfy themselves by inspection or otherwise as to their accuracy. No person in this firms employment has the authority to make or give any representation or warranty in respect of the property. Edmondson Estates have not tested any services, equipment, or facilities within the premises and will not be liable, in negligence or otherwise, for any loss arising from the use of these particulars.