



**5a Main Street**  
Killough  
BT30 7QD

**Offers In The Region Of  
£185,000**

- Four Bed Family Home
- Sizeable Living Room with Open Fire
- Kitchen with Dining Space
- Dining Room / Second Reception
- Utility Room
- Off Street Parking
- Extensive Garden & Shoreline Aspects
- Chain Free Sale
- Viewing By Appointment
- Enquires to Edel on 07703 612 257



| Energy Efficiency Rating                    |         |           |
|---|---------|-----------|
|   | Current | Potential |
| Very energy efficient - lower running costs |         |           |
| (92 plus) A                                 |         |           |
| (81-91) B                                   |         |           |
| (69-80) C                                   |         | 69        |
| (55-68) D                                   | 52      |           |
| (39-54) E                                   |         |           |
| (21-38) F                                   |         |           |
| (1-20) G                                    |         |           |
| Not energy efficient - higher running costs |         |           |

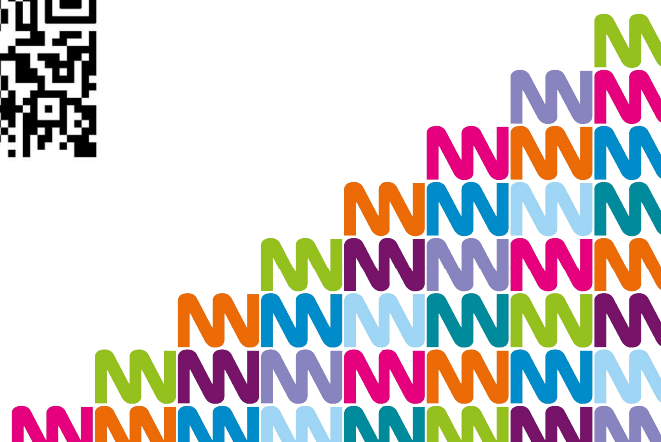





We are delighted to welcome to the sales market, this end terrace home, fronting onto Main Street in the coastal village of Killough, approximately five miles southeast of Downpatrick and within short walking distance of the harbour, beach and costal walks.

Viewing is highly recommended, and can be arranged by contacting Edel Curran on 07703 612 257.

### ACCOMMODATION

The property includes on the ground floor, a spacious living room with open fire, dining room, kitchen with dining space, utility room and bathroom, while the first floor houses four double bedrooms.

### OUTSIDE

Externally the driveway to the side of the property leads to a large, private garden, with pedestrian access to the public walkway with superb coastal views.

### MORTGAGE ADVICE

If you require financial advice on the purchase of this property, please do not hesitate to contact Donnan Ritchie from Ritchie & McLean Mortgage Solutions on 07545 576 819 or email Donnan on [donnan@ritchiemclean.co.uk](mailto:donnan@ritchiemclean.co.uk)  
Donnan is based in our Downpatrick branch.

### CONTACT

To organise your viewing, please contact Edel on 07703 612 257 or [downpatrick@quinnestateagents.com](mailto:downpatrick@quinnestateagents.com)



For any enquiry relating to this property, please contact

**Edel Curran**

[edel@quinnestateagents.com](mailto:edel@quinnestateagents.com)  
07703612257

### Ballynahinch Branch

24 High Street  
Ballynahinch BT24 8AB  
028 9756 4400

### Downpatrick Branch

49-51 Market Street  
Downpatrick BT30 6LP  
028 4461 2100

### Banbridge Branch

18 Bridge Street  
Banbridge BT32 3JS  
028 4062 2226

### General Enquiries

[sales@quinnestateagents.com](mailto:sales@quinnestateagents.com)

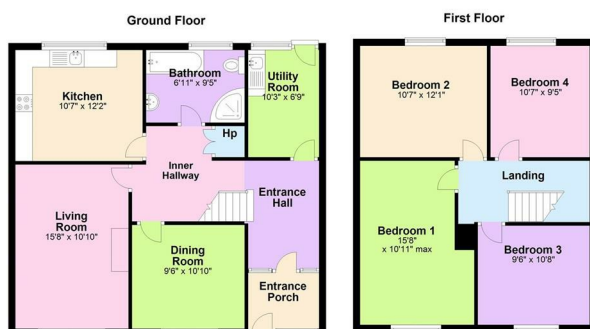

Terms & Conditions: Please note that these particulars do not constitute an offer or contract of sale. Any prospective purchaser should satisfy themselves by thorough inspection of the property and we recommend that any prospective purchaser should employ the professional services of a building surveyor and consider their findings prior to entering into contract. All such fees associated with this work will be the responsibility of the prospective purchaser regardless of whether the sale completes or not. In addition, none of the appliances or installations have been tested in any way whatsoever and it is our recommendation that a purchaser should fully satisfy themselves by employing an appropriate expert. We would also like to advise that our measurements are taken from the widest points of each room and should not be relied upon as completely accurate. You should not make decisions based on the measurements provided and double check measurements at all times. Valuation/Mortgage Service: As part of our service we would remind Vendors and potential purchasers that we have a Mortgage Broker available at this branch. If you are thinking of selling, we would be happy to carry out a free market appraisal of your property.

**QUINN**  
Estate Agents

[quinnestateagents.com](http://quinnestateagents.com)