

Your Local Property Experts



27 Fir Drive , Newtownards, BT23 4HH

"Don't need 3 bedrooms...? Don't pay for 3 bedrooms!"

If 2 bedrooms are enough then you could be the ideal buyer for this beautifully presented end of terrace home and your money could go towards a "turnkey" standard home instead. The property is immaculately presented from top to bottom, inside and out and is ready for immediate occupation. Both bedrooms benefit from built in storage cupboards whilst the modern, fully tiled shower room is both practical and appealing in equal measure. The ground floor offers equally sized lounge and kitchen/diner plus a separate utility/storage room. Both the lounge and kitchen continue that theme of exceptional presentation with real wood flooring to the lounge & entrance hall and light oak units with part tiled walls and tile flooring to the kitchen. It benefits from uPVC double glazing & fascia and Phoenix gas central heating.

Externally there are pleasant gardens to front & rear with a large communal green to the front & side plus a newly built playground to the side.

A great first home, fresh start or buy to let investment - internal viewing is a must.

Offers Around £94,950

27 Fir Drive

, Newtownards, BT23 4HH



- Beautifully presented end terrace home
- Modern kitchen with dining area
- uPVC double glazing - Phoenix gas central heating
- On street parking available to side of property.
- 2 bedrooms
- Luxury shower room
- Oak internal doors
- Lounge with feature fireplace
- Utility room
- Gardens to front and rear in lawn with paved pathways.

Entrance

Entrance Hall

Lounge

15'10x10'11 (4.83mx3.33m)

Kitchen/diner

15'9x10'5 (4.80mx3.18m)

Utility room

8'6x5'5 (2.59mx1.65m)

Landing

Shower room

6'1x5'5 (1.85mx1.65m)

Bedroom 1

15'10x9'5 (4.83mx2.87m)

Bedroom 2

9'6x8'6 (2.90mx2.59m)

Outside

Tenure

Property misdescriptions

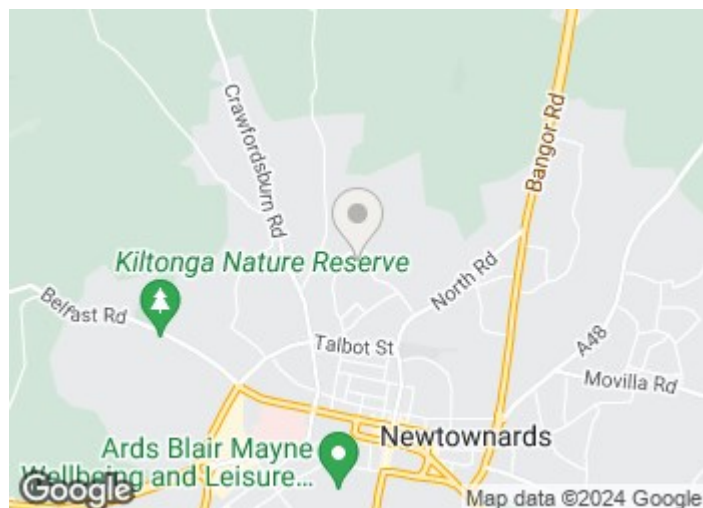

Directions

Travelling out of Newtownards along North Road turn left into Glenburn Road, Go straight over the mini roundabout and past the green then left into Fir Drive and number 27 is the last house on the right.



Floor Plan

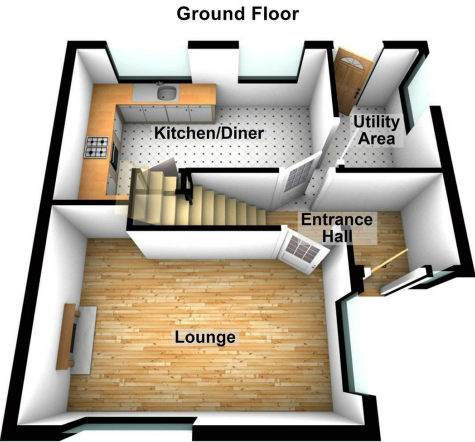

Images for illustrative purposes only and subject to change.
Plan produced using PlanUp.



These particulars, whilst believed to be accurate are set out as a general outline only for guidance and do not constitute any part of an offer or contract. Intending purchasers should not rely on them as statements of representation of fact, but must satisfy themselves by inspection or otherwise as to their accuracy. No person in this firms employment has the authority to make or give any representation or warranty in respect of the property.

