

## 23 Princetoon Walk , Portavogie, BT22 1FF

"The advice to sellers is often to "go neutral" but if you "like a bit of colour and character in your life" then 23 Princetoon Walk could be right up your street".

This modern semi detached home offers 3 first floor bedrooms, including a master with en-suite shower room, a family bathroom, a lounge, with feature cast iron stove, a kitchen/diner, with breakfast bar, and also benefits from a generous sun room extension to the rear plus a detached garage.

There is loads of room here for first time and family buyers alike and the driveway is a great size for anyone with more than one vehicle. It benefits from uPVC double glazing and oil fired central heating whilst, externally, there are gardens to both front and rear in lawn with paved patio and a pleasant green to the front. One of Portavogies best kept secrets is its beautiful, and often empty, beach, which is just a short distance from this property, as is the local primary school and other local amenities, including the Quays restaurant.

**Offers Around £155,000**

# 23 Princeton Walk

, Portavogie, BT22 1FF



- Extended semi detached home
- Kitchen with dining area & breakfast bar
- Detached garage with generous driveway
- Pleasant green to the front - Short distance to the beach
- 3 bedrooms (master en-suite)
- Sun room to rear
- uPVC double glazing - Oil fired central heating
- Lounge with feature fireplace
- Family bathroom
- Gardens to front & rear in lawn

## Entrance

## Entrance hall

## Lounge

14'4x12'11 (4.37mx3.94m)

## Kitchen/diner

21'3x11'1 (6.48mx3.38m)

## Sun room

13'4x11'2 (4.06mx3.40m)

## Cloakroom

3'11x5'4 (1.19mx1.63m)

## Landing

## Bathroom

8'6x7'8 (2.59mx2.34m)

## Bedroom 1

17x11'9 (5.18mx3.58m)

## Ensuite shower room

9x4'5 (2.74mx1.35m)

## Bedroom 2

11x8'6 (3.35mx2.59m)

## Bedroom 3

10'11x9'3 (3.33mx2.82m)

## Detached garage

19x11'5 (5.79mx3.48m)

## Outside

## Tenure

## Property misdescriptions



## Directions

Travelling along Main Road, Portavogie turn into the Princeton development. Turn right at the T junction then right again into the cul de sac to where number 23 is on the right, near the end.







Floor Plan

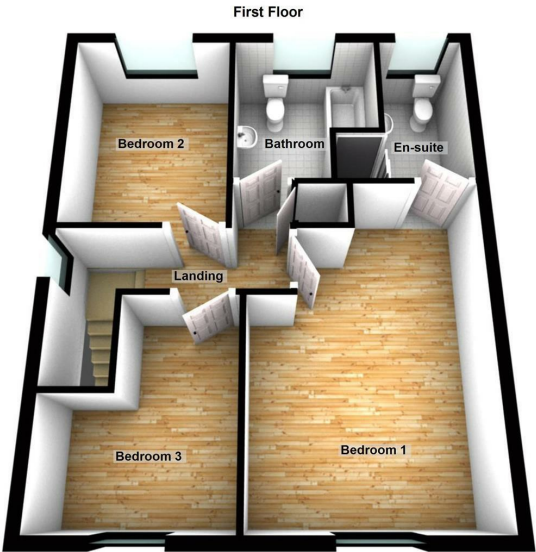
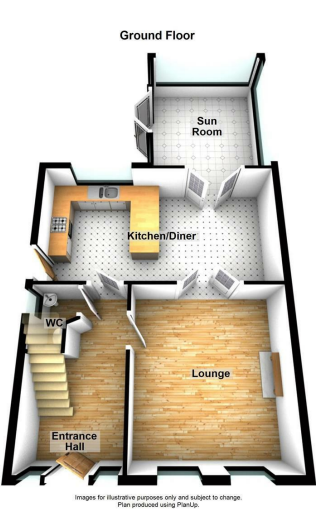

These particulars, whilst believed to be accurate are set out as a general outline only for guidance and do not constitute any part of an offer or contract. Intending purchasers should not rely on them as statements of representation of fact, but must satisfy themselves by inspection or otherwise as to their accuracy. No person in this firms employment has the authority to make or give any representation or warranty in respect of the property.

