



An opportunity exists to purchase 8.15 acres or thereabouts of high quality agricultural lands contained in two fields.

The lands are divided into two fields the majority of which have been re-seeded in the last two years and appear to be in excellent heart.

The lands are thought suitable for cutting, grazing or arable purposes. Mains water is laid on to the lands.

The lands are ideal for those wishing to extend their existing holding or purchase a portion of land to commence farming, graze livestock or for amenity or leisure purposes.

Viewing: Anytime

For Sale By Private Treaty  
High Quality Agricultural Lands  
Adjacent To 131 Upper Mealough Road  
Carryduff  
BT8 8JA

Offers Around  
£150,000

[www.timmartin.co.uk](http://www.timmartin.co.uk)  
Telephone 028 97 568300

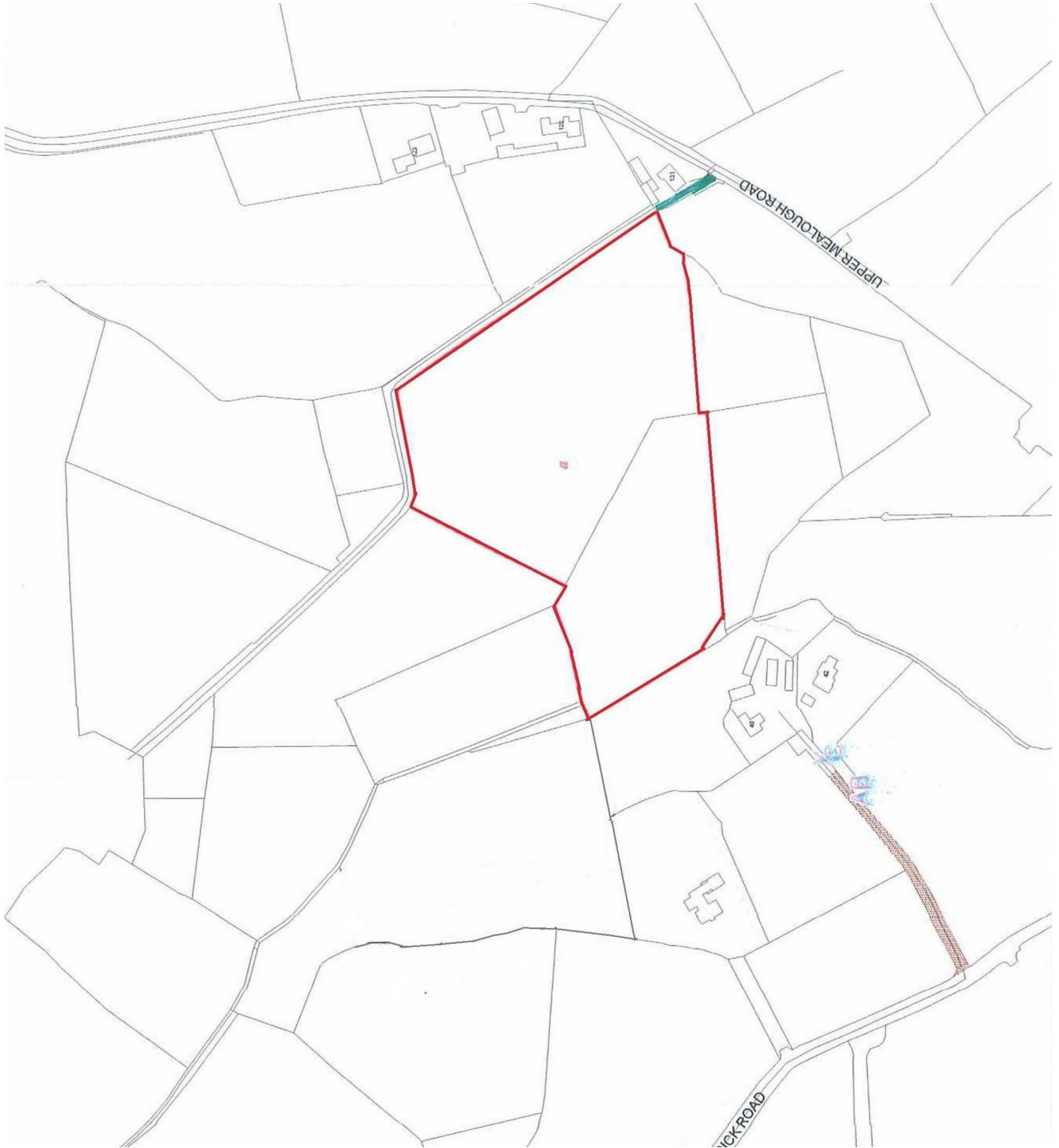

Comber ■  
27 Castle Street, Comber, BT23 5DY  
T 028 91 8789596

Saintfield  
1B Main Street, Saintfield, BT24  
7AA  
T 028 97 568300

Tim Martin & Company for themselves and for the vendors of this property have endeavoured to prepare these sales details as accurate and reliable as possible for the guidance of intending purchasers or lessees. These particulars are given for general guidance only and do not constitute any part of an offer or contract. The seller and us as agents, do not make any representation or give any warranty in relation to the property. We would recommend that all information contained in this brochure about the property be verified by yourself or professional advisors. Services, fittings and equipment referred to in the sales details have not been tested (unless otherwise stated) and no warranty will be given as to their condition. All measurements contained within this brochure are approximate. Please contact us prior to viewing the property. If there is any point of particular importance to you we would be pleased to provide additional information or make further enquiries. We will also confirm that the property remains available. This is particularly important if you are contemplating travelling some distance to view the property.