



## 15 Forest Grove, Newtownbreda road, Belfast, BT8 6AR

**Asking Price £179,950**

Forest Grove is a small, residential development located just off the Newtownbreda Road in the ever popular South East Belfast. With an excellent selection of schools, shopping facilities, open green areas and transport facilities all within walking distance, it is the perfect location to take advantage of all that the area has to offer.

This particular apartment offers spacious, well proportioned accommodation comprising lounge with double doors to modern fitted kitchen / diner (utility storage cupboard with space for washing machine and tumble dryer), the double doors giving the option for a more open plan layout whilst also enabling the two areas to be separated when required. Two double bedrooms both with en-suite and a guest w/c off the entrance hall.

Outside there is designated and communal parking as well as communal gardens and wooden deck area. This is a fantastic apartment that would suit both the first time buyer and those hoping to down size for some hassle free living.

- Spacious Ground Floor Apartment
- Lounge With Double Doors to Kitchen
- Guest W/C
- Double Glazing
- Communal Gardens and Decked Area
- Two Double Bedrooms, Both En-Suite
- Large Kitchen / Dining With Utility Cupboard
- Gas Heating
- Communal & Designated Parking
- Convenient Location To The Outer Ring

| Energy Efficiency Rating                    |   |         |           |
|---|---|---------|-----------|
| Very energy efficient - lower running costs |   | Current | Potential |
| (92-100)                                    | A |         |           |
| (81-91)                                     | B |         |           |
| (69-80)                                     | C |         |           |
| (55-68)                                     | D |         |           |
| (39-54)                                     | E |         |           |
| (21-38)                                     | F |         |           |
| (1-20)                                      | G |         |           |
| Not energy efficient - higher running costs |   |         |           |
| Northern Ireland                            |   | 75      | 76        |
| EU Directive 2002/91/EC                     |   |         |           |



**The Accommodation Comprises**  
Upvc double glazed front door to entrance.

### **Entrance Hall**



Oak flooring.

### **Guest W/C**



Cloakroom with low flush w.c. and wash hand basin, tiled floor.



### Lounge 14'10 x 10'2 (4.52m x 3.10m)



Oak flooring, double doors to fitted kitchen / dining.



### Fitted Kitchen / Dining



At widest points. Full range of high and low level built in units, built-in 4 gas hob and electric oven. Integrated fridge freezer, plumbed for washing machine 1 ¼ bowl stainless steel sink unit with mixer taps. Gas boiler, Utility storage cupboard that has been plumbed for washing machine and also houses a tumble dryer, Part tiled walls, tiled floor, spotlights.



**Bedroom One 12'10 x 10'6 (3.91m x 3.20m)**



**Laminate floor. Built in robes, Patio doors to providing access to communal gardens and decked area to the rear.**



### En-Suite Bathroom



White suite comprising shower bath, shower above, part pvc panelled walls, pedestal wash hand basin, low flush w.c, tiled floor.

### Bedroom Two 11'11 x 9'10 (3.63m x 3.00m)





### En-Suite



Comprising fully tiled shower cubicle, pedestal wash hand basin, low flush w/c, tiled floor.

### Outside



To the side of the property there is communal and designated parking. To the rear there are communal gardens and decked patio area.

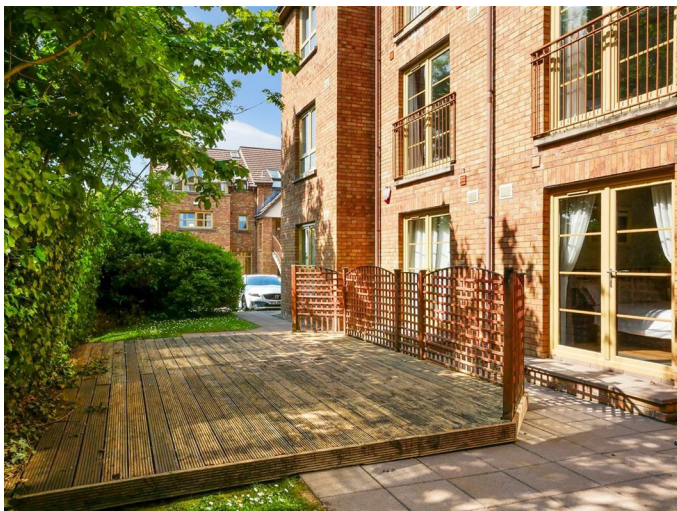

### Management Company

Managing agent details are below:

CSM Property Management Ltd

238A Kingsway

Dunmurry

BELFAST

BT17 9AE

25th Feb Service Charge for period 1st Jan 25 to 31st Dec 25 £902.02

Floor Plan

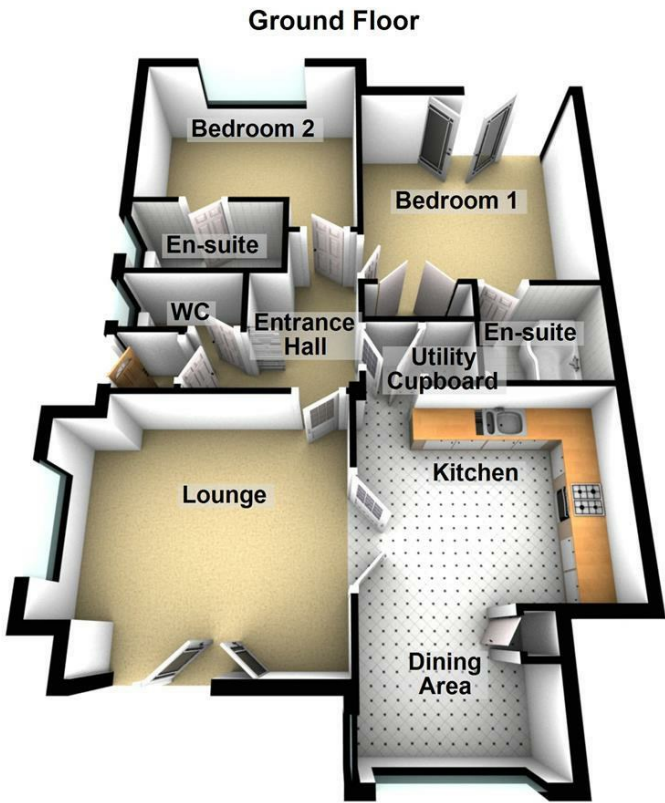

Area Map

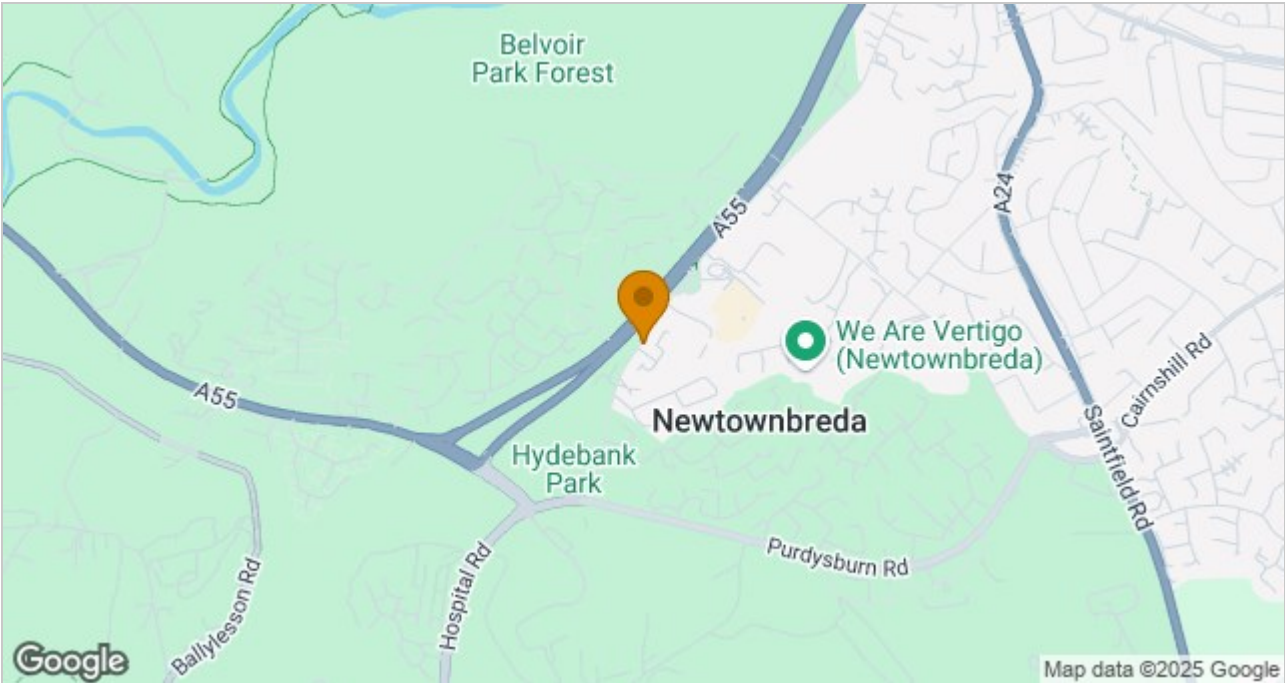

These particulars, whilst believed to be accurate are set out as a general outline only for guidance and do not constitute any part of an offer or contract. Intending purchasers should not rely on them as statements of representation of fact, but must satisfy themselves by inspection or otherwise as to their accuracy. No person in this firms employment has the authority to make or give any representation or warranty in respect of the property.

ULSTERPROPERTYSALES.CO.UK

**ANDERSONSTOWN**  
028 9060 5200  
**BALLYHACKAMORE**  
028 9047 1515  
**BALLYNAHINCH**  
028 9756 1155

**BANGOR**  
028 9127 1185  
**CARRICKFERGUS**  
028 9336 5986  
**CAVEHILL**  
028 9072 9270

**DONAGHADEE**  
028 9188 8000  
**DOWNPATRICK**  
028 4461 4101  
**FORESTSIDE**  
028 9064 1264

**GLENGORMLEY**  
028 9083 3295  
**MALONE**  
028 9066 1929  
**NEWTOWNARDS**  
028 9181 1444

**RENTAL DIVISION**  
028 9070 1000



Forestsides Estates Ltd; Trading under licence as Ulster Property Sales (Forestsides) Reg. No. N1051121; Registered Office: 9 Upper Crescent, Belfast BT7 1NT ©Ulster Property Sales is a Registered Trademark