



## 4 Alt-Min Avenue, Belfast, BT8 6NJ

**Asking Price £200,000**

Alt-Min Avenue is a small cul de sac positioned just off Carnbrae Avenue in the Four Winds.

Internally this Semi Detached home offers well proportioned accommodation comprising three good sized bedrooms, through lounge / dining room, fitted kitchen, upvc conservatory and a coloured bathroom suite on the first floor.

In addition the property benefits from oil fired central heating, double glazing, a driveway with off street parking and enclosed rear garden.

The property is also in walking distance to the convenient shops off Newton Park, a selection of primary & post primary schools, transport links to include the Cairnshill Park & Ride and Forestside Shopping Centre. An excellent first time purchase and or family home.

- Semi-Detached Home
- Through Lounge / Dining Room
- Coloured Bathroom Suite
- Oil Heating / Double Glazed
- Driveway with Off Street Parking
- Three Good Sized Bedrooms
- Fitted Kitchen
- Upvc Conservatory
- Enclosed Rear Garden
- Excellent Location in Quiet Cul-de-Sac

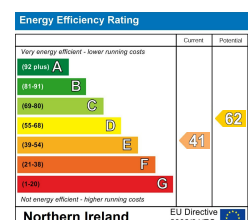



### **Porch**

Glazed patio door opens onto inner porch with tiled flooring.

### **Entrance Hall 13'9" x 7'0" (4.20m x 2.15m)**



Double glazed hardwood front door and surround opens onto spacious entrance hall.

### **Lounge / Dining Room 22'10" x 11'3" (6.96m x 3.43m)**



(at widest points) Through lounge / dining room with fireplace and raised dining area.



### **Fitted Kitchen 12'0" x 7'8" (3.66m x 2.36m)**



Fitted kitchen with selection of upper and lower level units complete with formica worktops and stainless steel sink with drainer. Wooden effect vinyl flooring and part tiled walls.

### **Sunroom 9'8" x 9'3" (2.96m x 2.82m)**



Upvc glazed sunroom with access to storage cupboard housing oil boiler.



## First Floor

Access to floored roof space

**Bedroom 1 11'4" x 10'6" (3.46m x 3.21m)**



**Bedroom 2 11'2" x 10'6" (3.41m x 3.21m)**



Built-in wardrobes and drawers.

**Bedroom 3 8'2" x 7'11" (2.50m x 2.43m)**



Built-in storage cupboard.

**Bathroom 7'9" x 6'5" (2.37m x 1.97m)**



Fitted bathroom suite complete with panelled bath, pedestal wash hand basin and low flush w.c. Access to hot press. Tiled walls and wooden effect vinyl flooring.

## Property Front



Garden to front with laid lawn and driveway to the side with off street parking.

## Enclosed Rear Garden



Enclosed rear garden with mature trees and hedges.

### Disclaimer

Please note that all services and appliances have not, and will not be tested.

Floor Plan

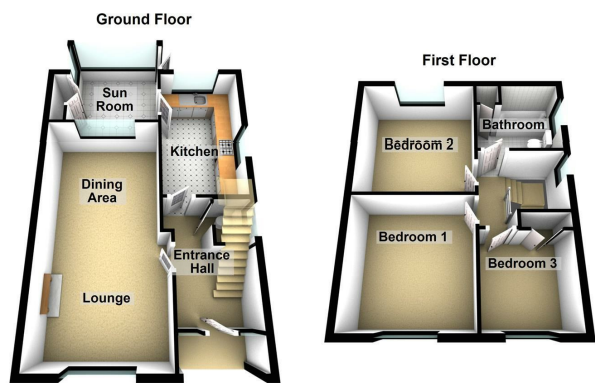

Area Map

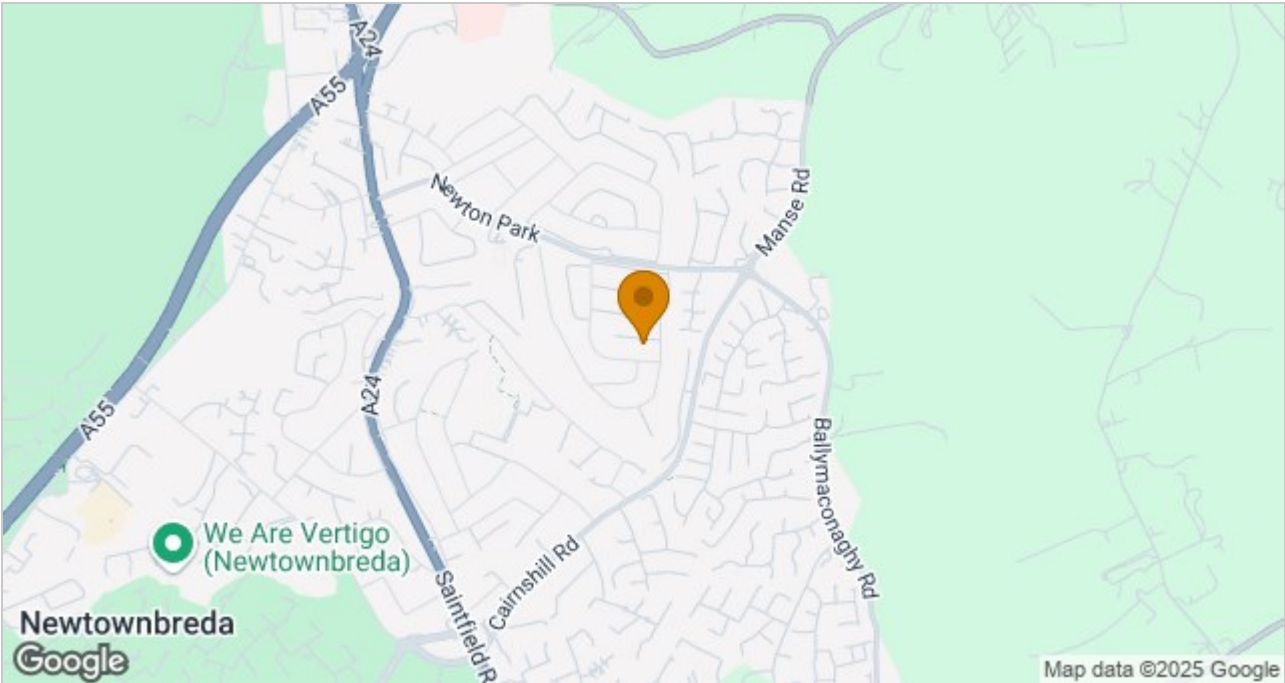

These particulars, whilst believed to be accurate are set out as a general outline only for guidance and do not constitute any part of an offer or contract. Intending purchasers should not rely on them as statements of representation of fact, but must satisfy themselves by inspection or otherwise as to their accuracy. No person in this firms employment has the authority to make or give any representation or warranty in respect of the property.

ULSTERPROPERTYSALES.CO.UK

ANDERSONSTOWN 028 9060 5200	BANGOR 028 9127 1185	DONAGHADEE 028 9188 8000	GLENGORMLEY 028 9083 3295	RENTAL DIVISION 028 9070 1000
BALLYHACKAMORE 028 9047 1515	CARRICKFERGUS 028 9336 5986	DOWNPATRICK 028 4461 4101	MALONE 028 9066 1929	
BALLYNAHINCH 028 9756 1155	CAVEHILL 028 9072 9270	FORESTSIDE 028 9064 1264	NEWTOWNARDS 028 9181 1444	



John Thompson trading under licence as Ulster Property Sales (Downpatrick)  
©Ulster Property Sales is a Registered Trademark