



## 29 Chadwick Street, Belfast, BT9 7FD

**Price Guide £160,000**

Situated just off the Lisburn Road, this mid terrace property is ideal for the the first time buyer or investor alike. Benefiting from excellent accommodation comprising two receptions, kitchen, two good sized bedrooms and first floor bathroom suite. Oil fired central heating and double glazed windows are both in place. Outside there is an enclosed yard to rear. Within close proximity to a range of amenities including the vast array of shops and restaurants on the Lisburn Road, City Centre and Queens University this property represents excellent value for money and will prove to be a worthwhile investment.

- Mid-Terrace Property
- Two Reception Rooms
- Double Glazed Windows
- Ideal First Time Buy / Investment Opportunity
- Two Good Sized Bedrooms
- First Floor Bathroom Suite
- Oil Fired Central Heating
- Convenient Location Within Walking Distance To Shops, Cafes & Restaurants Of Lisburn Road

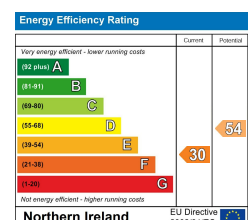



**THE ACCOMMODATION COMPRISES**  
**ON THE GROUND FLOOR**

Built in storage.

**LIVING ROOM 9'10" x 9'2" (3.0 x 2.8)**



Laminate floor.

**DINING ROOM 9'10" x 9'6" (3.0 x 2.9)**



Laminate floor with feature fireplace.

**KITCHEN 12'1" x 5'6" (3.7 x 1.7)**



Range of high and low level units, stainless steel extractor fan, stainless steel sink unit with drainer and mixer tap, plumbed for

washing machine, part tiled walls and tiled floor. Under stairs storage.

**ON THE FIRST FLOOR**

Built in storage.

**BEDROOM ONE 13'1" x 9'10" (4.0 x 3.0)**



**BEDROOM TWO 9'10" x 8'2" (3.0 x 2.5)**



Feature fireplace

**BATHROOM**



White suite comprising, Low flush W.C, pedestal wash hand basin, panel bath with Redring electric shower over, tiled walls and tiled floor. Built in storage.

**OUTSIDE**

Enclosed yard to rear.

Floor Plan

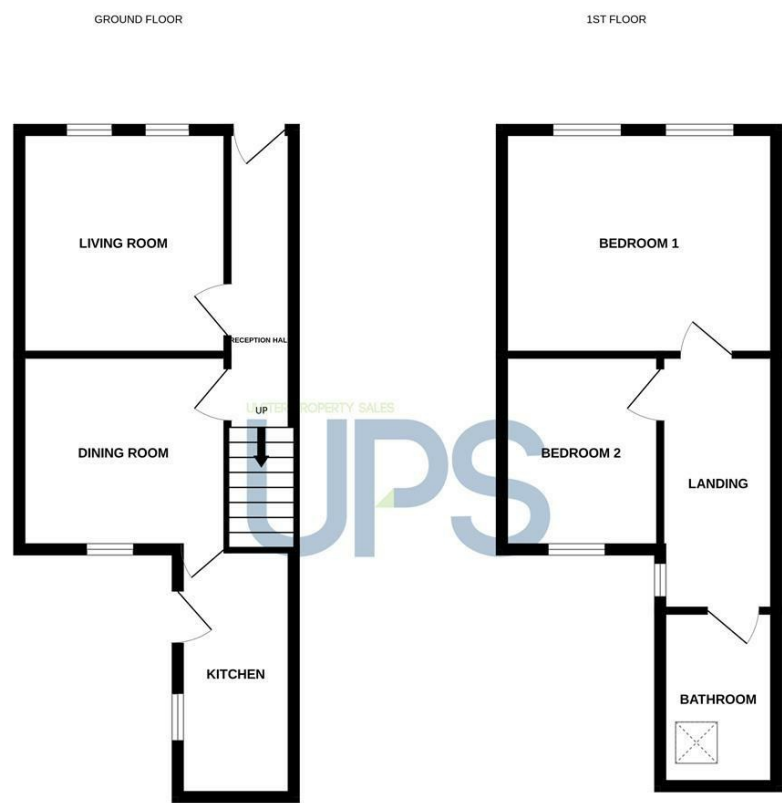

Whilst every attempt has been made to ensure the accuracy of the floorplan contained here, measurements of doors, windows, floors and any other items are approximate and no responsibility is taken for any error, omission or mis-statement. This plan is for illustrative purposes only and should be used as such by any prospective purchaser. The services, systems and appliances shown have not been tested and no guarantee as to their operability or efficiency can be given.  
Made with floorplan 32024

Area Map



These particulars, whilst believed to be accurate are set out as a general outline only for guidance and do not constitute any part of an offer or contract. Intending purchasers should not rely on them as statements of representation of fact, but must satisfy themselves by inspection or otherwise as to their accuracy. No person in this firms employment has the authority to make or give any representation or warranty in respect of the property.

ULSTERPROPERTYSALES.CO.UK

ANDERSONSTOWN 028 9060 5200	BALLYNAHINCH 028 9756 1155	CAUSEWAY COAST 0800 644 4432	FORESTSIDE 028 9064 1264	NEWTOWNARDS 028 9181 1444
BALLYHACKAMORE 028 9047 1515	BANGOR 028 9127 1185	CAVEHILL 028 9072 9270	GLENGORMLEY 028 9083 3295	RENTAL DIVISION 028 9070 1000
BALLYMENA 028 2565 7700	CARRICKFERGUS 028 9336 5986	DOWNPATRICK 028 4461 4101	MALONE 028 9066 1929	



John Thompson trading under licence as Ulster Property Sales (Downpatrick)  
©Ulster Property Sales is a Registered Trademark