

ULSTER PROPERTY SALES

# UPS

## RENTALS - NEWTOWNARDS

46 High Street, Newtownards, BT23 7HZ

028 9070 1000

rentals@ulsterpropertysales.co.uk

NETWORK STRENGTH - LOCAL KNOWLEDGE



### 3 AUDLEYS CLOSE, NEWTOWNARDS, BT23 8WF

| Energy Efficiency Rating  |         |                         |
|---|---------|-------------------------|
| Very energy efficient - lower heating costs                             | Current | Potential               |
| 100-91 kWh/m <sup>2</sup> A   |         |                         |
| 91-81 kWh/m <sup>2</sup> B  |         |                         |
| 81-65 kWh/m <sup>2</sup> C  |         |                         |
| 65-55 kWh/m <sup>2</sup> D  |         |                         |
| 55-45 kWh/m <sup>2</sup> E  |         |                         |
| 45-35 kWh/m <sup>2</sup> F  |         |                         |
| 35-25 kWh/m <sup>2</sup> G  |         |                         |
| Below 25 kWh/m <sup>2</sup> Not energy efficient - higher heating costs |         |                         |
| Northern Ireland  |         | EU Directive 2002/91/EC |

## £1,450 PER MONTH





Welcome to Audleys Close, Newtownards - a popular location for this detached four-bedroom house. This property boasts a large double-storey extension, offering space for a growing family or those who love to entertain.

As you step inside, you are greeted by separate living and lounge areas, providing versatility for relaxation and socialising. The open-plan kitchen and dining room are perfect for hosting dinner parties or enjoying family meals together, with the added convenience of a separate utility room.

Upstairs, you will find four bedrooms, including a master bedroom with a built-in shower for added luxury and convenience. The property has been well maintained, ensuring that you can move in and start enjoying your new home straight away.

Don't miss out on the opportunity to make this house your home - schedule a viewing today and experience the potential and comfort that this property has to offer.

**\*\* Note pictures shown are historic and subject to slight change \*\***





## Key Features

- Detached Four Bedroom Property With Large Double Storey Extension
- Separate Livingroom And Lounge Areas
- Ground Floor Toilet Suite And Additional First Floor Family Bathroom
- Open Plan Kitchen/Dining Room With Separate Utility Room
- Four Bedrooms On The First Floor, Master With Built-In Shower
- Well Maintained & Decorated To A Good Standard Throughout
- Gas Fired Central Heating System And uPVC Double Glazed Windows
- Early Viewing Is Highly Recommended For This Family Home



### Accommodation Comprises;

#### Entrance Hallway

Tiled flooring.

#### Living Room

13'5" x 14'6"

Wood laminate flooring.

#### Dining Room

9'3" x 20'9"

Wood laminate flooring, patio doors to rear garden, under staircase storage.

#### Kitchen

9'2" x 22'5"

Modern range of high and low level units, laminate work surfaces, integrated appliances to include; fridge/freezer, electric under oven, inset composite sink unit with mixer tap, tiled flooring, four ring gas hob with stainless steel extractor fan and hood, space for informal dining, recessed spotlights.

#### Utility Room

Modern range of high and low level units, laminate work surfaces, tiled flooring, plumbed for washing machine and space for tumble dryer.

#### Ground Floor W/C

White suite comprising low flush w.c., wall mounted wash hand basin with tiled splashback, laminate flooring and extractor fan.

#### Lounge

9'4" x 14'3"

Wood laminate flooring.

#### First Floor

#### Landing

Built in storage.

#### Bathroom

White suite comprising low flush w.c., semi pedestal wash hand basin with mixer tap, panelled bath, recessed spotlights, fully tiled walls, tiled flooring.

#### Bedroom 1

9'4" x 18'4"

Double bedroom with built in wardrobe.

#### En-Suite

White suite comprising low flush w.c., vanity unit with wash hand basin with mixer tap, tiled shower enclosure with overhead shower and glazed door, recessed spotlights, fully tiled walls, tiled flooring.

#### Bedroom 2

9'10" x 10'8"

Double bedroom, built in wardrobe, wood laminate flooring.

#### Bedroom 3

10'8" x 9'4"

Wood laminate flooring.

#### Bedroom 4

7'5" x 7'4"

Wood laminate flooring.



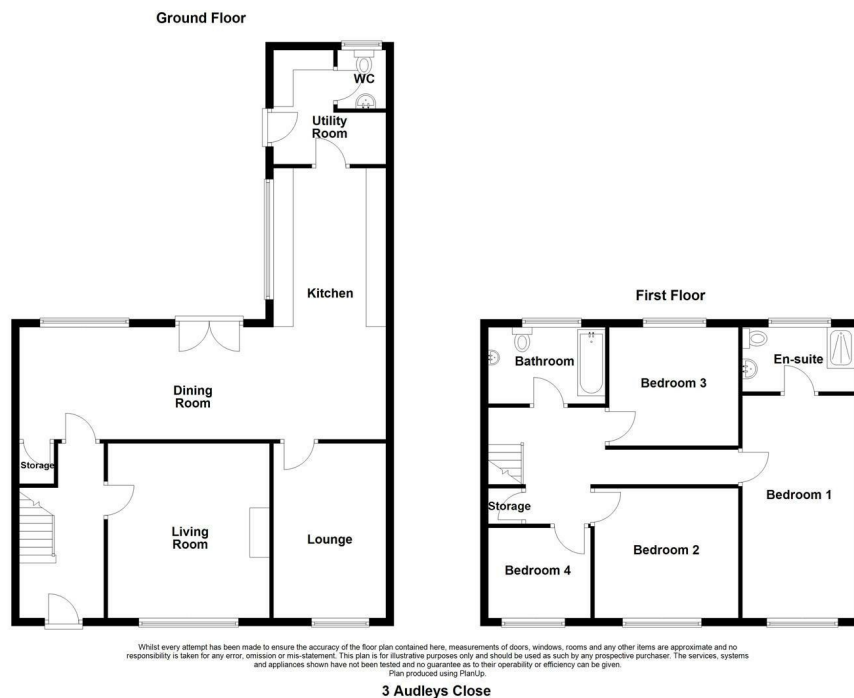

Questions you may have. **Which mortgage would suit me best?**

**How much deposit will I need? What are my monthly repayments going to be?** To answer these and other mortgage related questions contact Mr Andrew Haylett on 07814878577.

Your home may be repossessed if you do not keep up repayments on your mortgage.

**We DO NOT charge for initial mortgage consultations. We may charge a fee on completion depending on circumstances. Our typical fee is £250, however, please confirm with Mortgage Consultant at time of appointment. 17996012**

Please note that we have not tested the services or systems in this property. Purchasers should make/commission their own inspections if they feel it is necessary.

ULSTERPROPERTYSALES.CO.UK

ANDERSONSTOWN  
028 9060 5200  
BALLYHACKAMORE  
028 9047 1515  
BALLYNAHINCH  
028 9756 1155

BANGOR  
028 9127 1185  
CARRICKFERGUS  
028 9336 5986  
CAVEHILL  
028 9072 9270

DONAGHADEE  
028 9188 8000  
DOWNPATRICK  
028 4461 4101  
FORESTSIDE  
028 9064 1264

GLENGORMLEY  
028 9083 3295  
MALONE  
028 9066 1929  
NEWTOWNARDS  
028 9181 1444

RENTAL DIVISION  
028 9070 1000



Jonathan Collins trading under licence as Ulster Property Sales (North Down)  
©Ulster Property Sales is a Registered Trademark