



## 3 CASTLE PLACE

Newcastle BT33 0AB

- Large commercial premises
- 19 Bedrooms, all ensuite
- Dining room
- Lounge
- Reception hall
- Ideal hotel
- Toilet facilities
- 3 Commercial units, Former restaurant
- Carparking
- Stunning views

Energy Efficiency Rating		
	Current	Potential
Very energy efficient - lower running costs		
(92 plus) <b>A</b>		
(81-91) <b>B</b>		
(69-80) <b>C</b>		
(55-68) <b>D</b>		
(39-54) <b>E</b>		
(21-38) <b>F</b>		
(1-20) <b>G</b>		
Not energy efficient - higher running costs		
Northern Ireland		
EU Directive 2002/91/EC		

**Asking Price £1,000,000**

# 3 Castle Place

, Newcastle, BT33 0AB

19

19

null



Entrance Porch

Reception

31'7" x 21'11" (9.62m x 6.68m)

Disabled W.C

Mens Toilets

8'4" x 11'8" (2.54m x 3.56m)

Womens Toilets

12'6" x 12'1" (3.81m x 3.68m)

LIFT

Office/ Store

6'2" x 10'4" (1.89m x 3.15m)

Lounge

15'7" x 17'7" (4.75m x 5.36m)

Dining Hall

23'4" x 41'8" (7.11m x 12.70m)

Dining Store

3'11" x 9'9" (1.20m x 2.98m)

Kitchen

17'9" x 4'8" (5.41m x 1.43m)

Cold Store

Plant Room

17'10" x 16'2" (5.44m x 4.93m)

Hall

59'3" x 3'4" (18.06m x 1.02m)

Store

WC

3'3" x 8'2" (1.00m x 2.50m)

Three retail Units (Currently integrated as one)

56'0" x 22'6" (17.07m x 6.86m)

Currently knocked into one unit. Former restaurant.

Reception Hall

Lift

Room 1

23'2" x 16'10" (7.06m x 5.13m)

En-suite

Room 2

11'7" x 23'10" (3.53m x 7.27m)

Ensuite

Room 3

11'2" x 23'10" (3.40m x 7.27m)

En-suite

Room 4

11'3" x 24'7" (3.43m x 7.50m)

En-suite

Room 5

11'9" x 23'10" (3.58m x 7.27m)

En-suite

Room 6

14'2" x 24'0" (4.32m x 7.32m)

En-suite

Door to:

Room 7

23'3" x 11'1" (7.09m x 3.38m)

En-suite

Room 8

23'3" x 11'11" (7.09m x 3.63m)

En-suite

Room 9

23'3" x 11'11" (7.09m x 3.63m)

En-suite

Room 10

23'3" x 11'1" (7.09m x 3.38m)

En-suite

7'0" x 5'10" (2.13m x 1.78m)

Room 11

23'3" x 11'11" (7.09m x 3.63m)

En-suite

Landing

15'9" x 28'4" (4.80m x 8.64m)

Lift

Room 12

23'0" x 18'11" (7.01m x 5.77m)

En-suite

Room 13

23'6" x 23'10" (7.16m x 7.27m)

En-suite



## Directions





Floor Plan

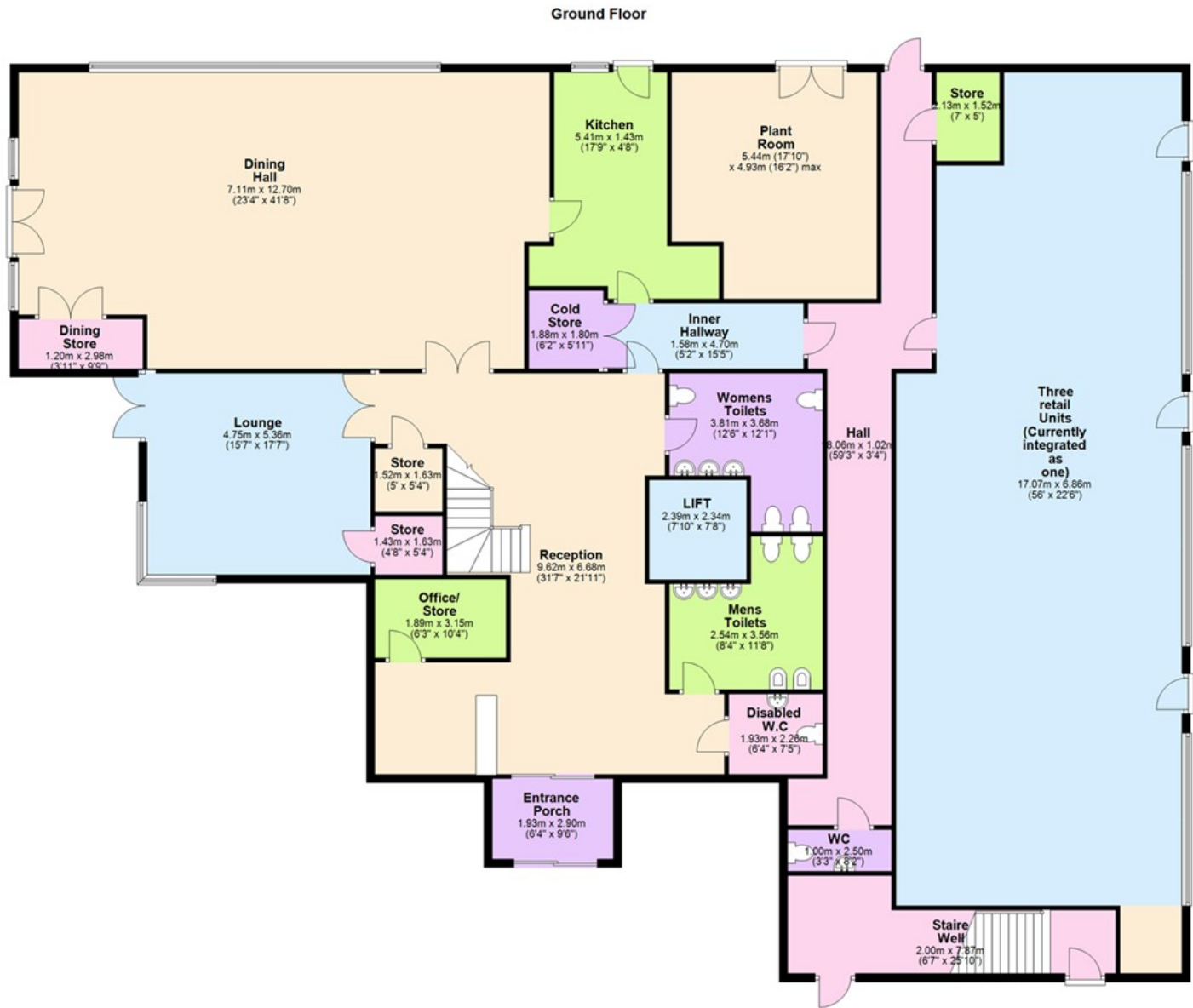

These particulars, whilst believed to be accurate are set out as a general outline only for guidance and do not constitute any part of an offer or contract. Intending purchasers should not rely on them as statements of representation of fact, but must satisfy themselves by inspection or otherwise as to their accuracy. No person in this firms employment has the authority to make or give any representation or warranty in respect of the property.

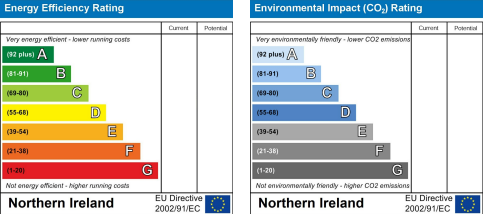

ULSTERPROPERTYSALES.CO.UK

ANDERSONSTOWN 028 9060 5200  
BALLYHACKAMORE 028 9047 1515  
BALLYNAHINCH 028 9756 1155

BANGOR 028 9127 1185  
CARRICKFERGUS 028 9336 5986  
CAVEHILL 028 9072 9270

DONAGHADEE 028 9188 8000  
DOWNPATRICK 028 4461 4101  
FORESTSIDE 028 9064 1264

GLENGORMLEY 028 9083 3295  
MALONE 028 9066 1929  
NEWTOWNARDS 028 9181 1444

RENTAL DIVISION 028 9070 1000



John Thompson trading under licence as Ulster Property Sales (Downpatrick)  
©Ulster Property Sales is a Registered Trademark