

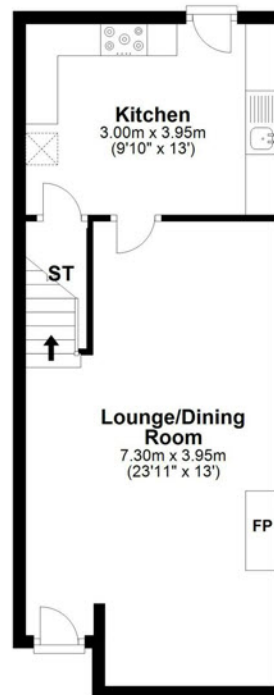

TEMPLETON  
ROBINSON

TEMPLETON  
ROBINSON

**Ground Floor**  
Approx. 47.8 sq. metres (514.5 sq. feet)



**First Floor**  
Approx. 41.1 sq. metres (442.5 sq. feet)

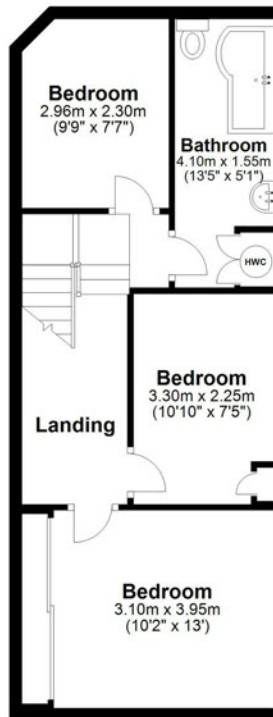

Total area: approx. 88.9 sq. metres (957.0 sq. feet)

This plan is for illustrative purposes only.  
Plan produced using PlanUp.

Lisburn - 028 92 66 1700  
Ballyhackamore - 028 90 65 0000  
Lisburn Road - 028 90 66 3030  
North Down - 028 90 42 4747

[www.templetonrobinson.com](http://www.templetonrobinson.com)



These particulars do not constitute any part of an offer or contract. None of the statements contained in these particulars are to be relied on as statements or representations of fact and intending purchasers must satisfy themselves by inspection or otherwise to the correctness of each of the statements contained in these particulars. The Vendor does not make or give, neither Templeton Robinson, nor any person in its employment has any authority to make or give, any representation or warranty whatever in relation to this property. All dimensions are taken to nearest 3 inches.

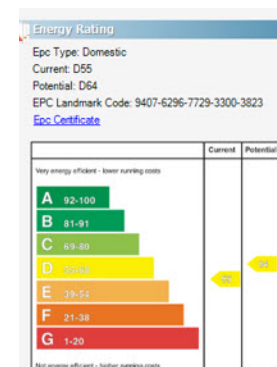

We are delighted to offer this well presented end terrace, conveniently located on Young Street. The property has been modernised throughout comprising a spacious living/dining room on the ground floor as well as a contemporary kitchen. On the first floor there is a spacious master bedroom with built-in mirrored wardrobes as well as two further bedrooms and a family bathroom.

Centrally located, this property is just minutes from Lisburn City Centre with shops, cafes and restaurants as well as Sprucefield Retail Park. The property is also close to public transport links including buses and trains as well as the M1 Motorway Network for commuting to Belfast.

With modern accommodation, matched with a central location, this property is sure to suit first time buyers and professional couples alike. Early viewing is recommended.

Offers Over  
£84,950

10 Young Street,  
LISBURN,  
BT27 5EB

Viewing by  
appointment with  
& through agent  
028 9266 1700



10 Young Street,  
LISBURN,  
BT27 5EB

# Property Features

- Well Presented End Terrace
- Modern Decor Throughout
- Spacious Living Accommodation Comprising Living/Dining Room
- Separate Kitchen With Modern Fitted Units
- Master Bedroom With Built-In Mirrored Wardrobes
- Two Further First Floor Bedrooms
- Family Bathroom With Bath/Shower Unit
- Enclosed Yard To Rear

# Location:

Travelling into Lisburn on Sloan Street, turn left at Sloan Street Church & continue on Young Street past the Riverside Centre - the property is located on the right.

# Property Comprises

## Ground Floor

LOUNGE: 12' 12" x 23' 11" (3.95m x 7.28m) at widest points.  
Feature fireplace with tiled hearth, laminate floor, bar.  
KITCHEN: 9' 9" x 12' 10" (2.98m x 3.91m) 1 1/2 stainless steel sink unit, high and low level units, tiled floor, part tiled walls, 5 ring gas hob, eye level oven, built in fridge, plumbed for washing machine, spotlighting.

## First Floor

LANDING: Access to attic.  
BEDROOM (1): 11' 1" x 10' 0" (3.38m x 3.05m) Built-in mirrored wardrobes.  
BEDROOM (2): 10' 10" x 7' 4" (3.31m x 2.24m) at widest points.  
BEDROOM (3): 7' 1" x 10' 3" (2.16m x 3.13m) at widest points.  
BATHROOM: Panel bath, shower over, low flush WC, pedestal wash hand basin, hot press, gas fired boiler.

## Outside

Enclosed rear yard, store with electric.

