



Computer visual.

The Fairview

Total Floor Area: 1065 sq ft / 99 sq. m approx.



49 Church Place, Lurgan
028 **3834 4888**
www.msrestateagents.com

ASHGROVE HEIGHTS

ASHGROVE ROAD
PORTADOWN

First Floor

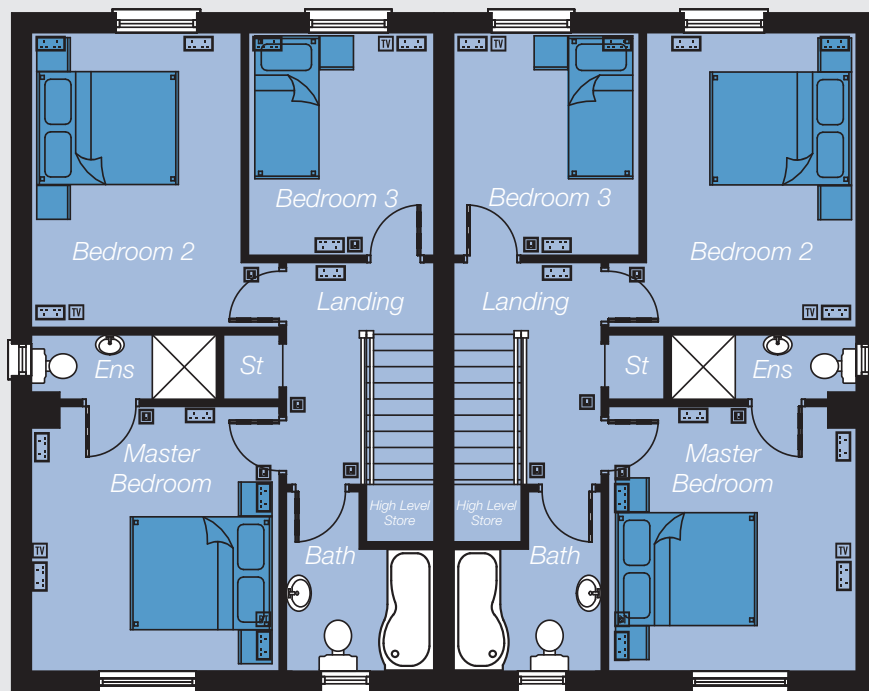

The Fairview

First Floor

Master Bed (Max)	12'0" x 11'3" 3.68m x 3.45m
Ensuite	
Bedroom 2 (Max)	13'5" x 11'3" 4.10m x 3.45m
Bedroom 3	9'10" x 8'6" 3.00m x 2.59m
Bathroom	8'10" x 6'9" 2.70m x 2.06m

Ground Floor

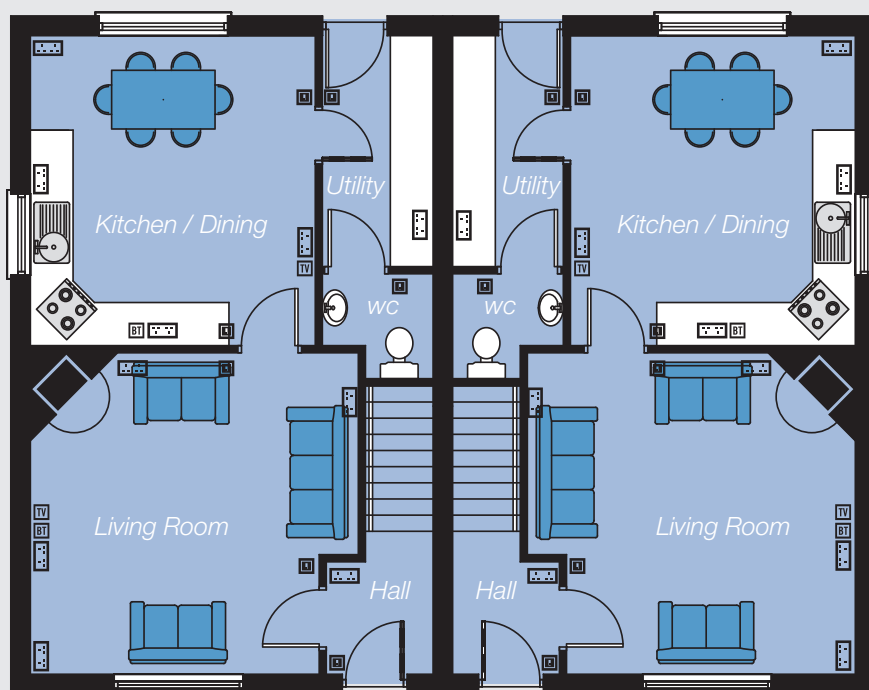

Ground Floor

Living Room (Max)	14'9" x 14'7" 4.50m x 4.475m
Kitchen / Dining	13'11" x 13'0" 4.26m x 3.97m
Utility Room	9'10" x 4'11" 3.00m x 1.50m
WC	

Total Floor Area:
1065 sq ft approx.
99 sq m approx.

Key

Socket	...
Light Switch	■
Telephone Connection Point	BT
Television Connection Point	TV

The computer visual on the other side of this insert is for illustrative purposes only. Floorplans above are not to scale and all measurements are approximate. Whilst every care is taken in preparing this information, no representation is given, and it does not form any part of a contract. Any intending purchaser must satisfy himself/herself as to the correctness of each of the statements contained in these particulars. We reserve the right to alter specifications without due notice.