



485 Lisburn Road, Belfast, BT9 7EZ
Tel: 02890 661111
Email: info@fetherstonclements.com
Web: www.fetherstonclements.com

6 Beech House

28 Beech Heights, Belfast
BT7 3LQ

Offers Over £199,950

6 BEECH HOUSE, WELLINGTON SQUARE, BELFAST, BT7 3LQ

- Modern 1st Floor Apartment within this Popular Development
- Generous Lounge with Bay Window
- Fitted Kitchen with Built in Appliances
- 3 Double Bedrooms, Including Master with Ensuite Shower Room
- Family Bathroom with White Suite
- Gas Central Heating/uPVC Double Glazed Windows/Ample Storage
- Well Presented Throughout
- Allocated Car Parking Space and Visitor Parking
- Convenient to many Amenities including Forestside Shopping Complex and Lagan Towpath
- Convenient to Leading Schools

This well presented 1st floor apartment is ideally located in a prime location within this popular cul de sac development.

The property is beautifully presented by the current owners and offers spacious accommodation which includes a generous lounge with open arch to a modern kitchen and three bedrooms, including master with ensuite. In addition the property benefits from a private, allocated car parking space and overlooks mature communal grounds.

Set in a convenient location, close to Belfast and convenient to a range of amenities including The Lagan Towpath, Belfast Boat Club and public transport, this property can only be fully appreciated on internal inspection.

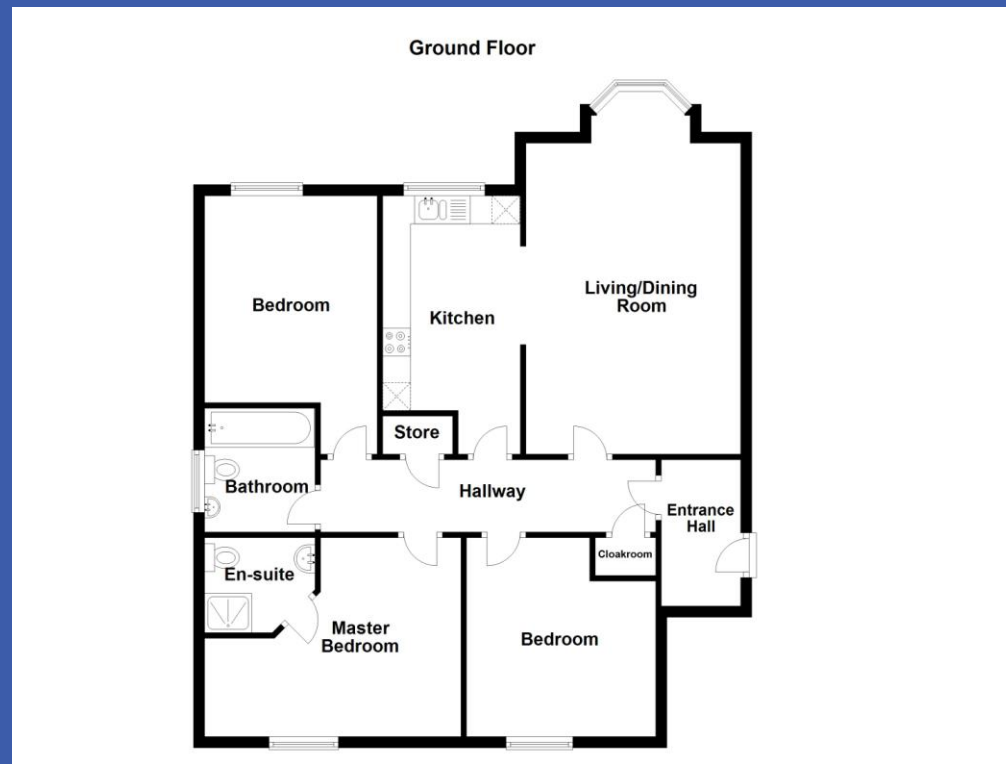





Property Comprise s

Communal front door to communal entrance hall, stairs and lift to 1st Floor

ENTRANCE PORCH

Oak flooring

ENTRANCE HALL

Oak flooring, 2 storage cupboards

LOUNGE 21' 6" x 12' 8" (6.55m x 3.86m)

Oak flooring, open arch to kitchen

KITCHEN 15' 1" x 8' 1" (4.6m x 2.46m)

Range of high and low level units, Granite work surfaces, 1.5 bowl stainless sink unit with Granite drainer, integrated dishwasher, integrated washing machine, 4 ring gas hob with stainless steel splash back, extractor fan and electric oven under, integrated fridge freezer, part tiled walls, tiled floor, concealed gas fired boiler, low voltage spots





BEDROOM 15' 5" x 11' 7" (4.7m x 3.53m)

ENSUITE

White suite comprising low flush wc, fully tiled shower cubicle, pedestal wash hand basin, part tiled walls, tiled floor. low voltage spots

BEDROOM 11' 8" x 10' 10" (3.56m x 3.3m)

BEDROOM 15' 11" x 10' 2" (4.85m x 3.1m)

BATHROOM

White suite comprising 1/2 pedestal wash hand basin, wc, part tiled walls, tiled floor, low voltage spots, extractor fan

OUTSIDE

Well maintained communal grounds. Allocated car parking space and visitor parking



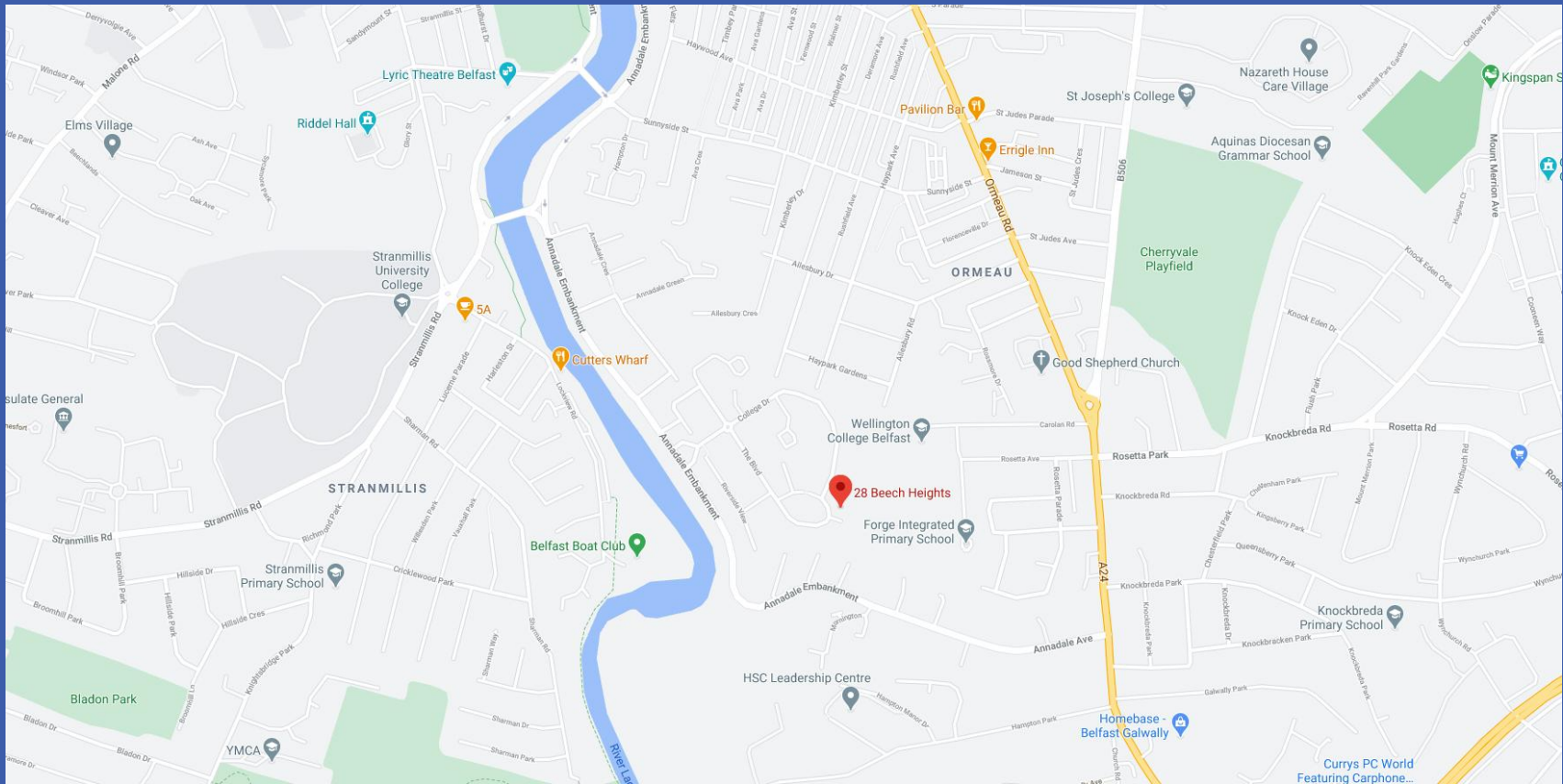

Directions:
From Annadale Embankment turn in to the Wellington Square development, at the first roundabout turn right on to The Boulevard and continue to Beech Heights



Fetherston Clements Estate Agents for themselves and for the Vendors or Lessors of the property whose agents they are give notice that; i) these particulars are given without responsibility of Fetherston Clements or the Vendors or Lessors as a general outline only, for the guidance of prospective purchasers or tenants, and do not constitute the whole or any part of an offer or contract; ii) Fetherston Clements cannot guarantee the accuracy of any description, dimensions, references to condition, necessary permissions for the use and occupation and other details contained herein and any prospective purchasers or tenants should not rely on them as statements of representation of fact but must satisfy themselves by inspection or otherwise as to the accuracy of each of them; iii) no employee of Fetherston Clements has authority to make or give any representation or warranty or enter into any contract whatsoever in relation to the property; iv) VAT may be payable on the purchase price and / or rent, all figures are quoted exclusive of VAT, intending purchasers or tenants must satisfy themselves as to the applicable VAT position, if necessary by taking the appropriate professional advice; v) Fetherston Clements will not be liable in negligence or otherwise, for any loss arising from the use of these particulars; vi) Appliances not tested or verified.