

Victoria Crescent, Lisburn, County
Down, BT27

Asking Price: £185,000
Freehold

 **Reeds Rains**

reedsrains.co.uk

Victoria Crescent, Lisburn, County Down, BT27
Asking Price: £185,000 Freehold

Council Tax Band:
EPC Rating: D

Charming Grade 2 listed period mid-terraced house with 3 bedrooms, located in a sought-after neighbourhood. This property boasts a spacious living area, modern kitchen, and a well-maintained garden. Close to local amenities and excellent transport links. Ideal for families or professionals looking for a stylish home. Viewing highly recommended.

Entrance Hall
Tiled flooring, panelling.

Living Room
11'7" x 11'3" (3.53m x 3.43m)
Feature fireplace with stove inset, tiled flooring, window shutters

Dining Room
11'9" x 10' (3.58m x 3.05m)
Tiled flooring, feature radiator, under stairs storage

Kitchen
12'11" x 8'6" (3.94m x 2.6m)
Exceptional range of modern fitted units, granite work tops, ceramic inlaid sink unit, wooden drainer, range cooker, tiled flooring,, extractor fan.

Utility / WC
8'6" x 2'9" (2.6m x 0.84m)
Range of units, plumbed for washing machine.

Landing

Bedroom 1
15'3" x 11'7" (4.65m x 3.53m)
Robes recess, window shutters.

Bathroom
Deluxe white suite comprising panelled bath, wash hand basin, low level WC, separate fully enclosed shower cubicle, shower unit with shower shower head, tiled flooring.

Landing

Bedroom 2
15'3" x 11'7" (4.65m x 3.53m)
Dormer windows, book shelving.

Bedroom 3
10' x 9'5" (3.05m x 2.87m)
Velux window.

Enclosed Rear Yard Area
Variety of plants shrubs, outside shed/ cabin.

The Reeds Rains branches at 350 Upper Newtownards Road, Ballyhackamore, Belfast, N Ireland BT4 3EX, 18 Main Street, Bangor, Co Down, N Ireland BT20 5AG, Somerset House, 240-242 Ormeau Road, Belfast, Co Antrim, N Ireland BT7 2FZ, 10 High Street, Carrickfergus, Co Antrim, N Ireland BT38 7AF, 8/8A Carnmoney Road, Glengormley, County Antrim, N Ireland BT36 6HN, 14/16 Market Street, Lisburn, County Antrim , N Ireland BT28 1AB and 2 Frances Street, Newtownards, County Down, N Ireland BT23 4JA are operated by Favsko NI Limited which is independently owned and operated under a Licence from Reeds Rains Limited.

All Measurements
All Measurements are Approximate.

Laser Tape Clause
All measurements have been taken using a laser tape measure and therefore, may be subject to a small margin of error.

Floorplan Clause
Measurements are approximate. Not to Scale. For illustrative purposes only.

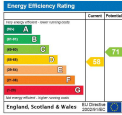

For full EPC please contact the branch.

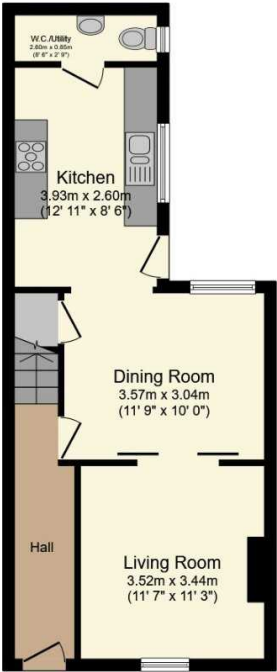

Ground Floor

Total floor area 99.0 sq.m. (1,066 sq.ft.) approx
Restricted height 5.0 sq.m. (54 sq.ft.)

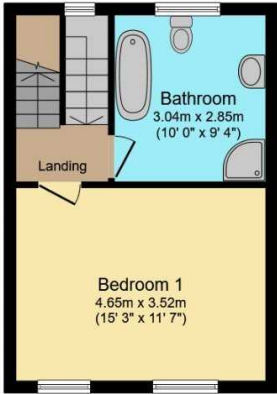

First Floor

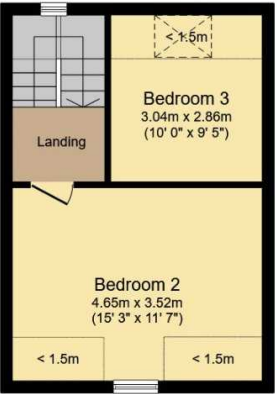

Second Floor

This floor plan is for illustrative purposes only. It is not drawn to scale. Any measurements, floor areas (including any total floor area), openings and orientation are approximate. No details are guaranteed, they cannot be relied upon for any purpose and they do not form part of any agreement. No liability is taken for any error, omission or misstatement. A party must rely upon its own inspection(s).
Powered by www.focalagent.com

We may refer you to recommended providers of ancillary services such as Conveyancing, Mortgages, Insurance and Surveying. We may receive a referral fee for recommending their services. You are not under any obligation to use the services of the recommended provider, which may also be an associated company of Reeds Rains.

Other important information which you will need to know about this property can be found at reedsrains.co.uk