

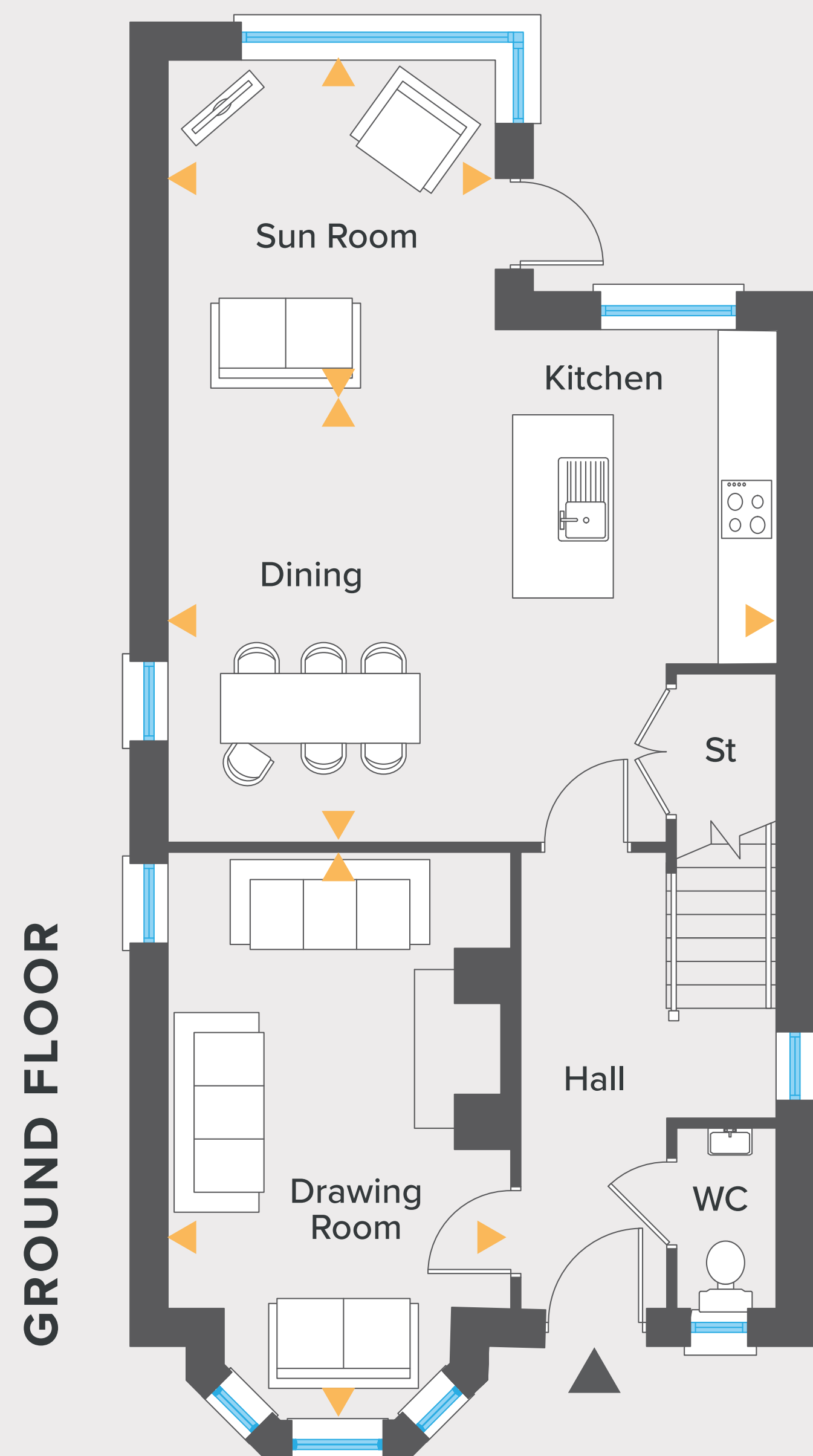

The Dixon (BH6a)

Render finish. Site nos. 10, 12

4 Bedroom | Detached | Total Area: 1428 sq ft



GROUND FLOOR

	Ft/Inch	Metres
Entrance Hall with separate WC		
Drawing Room inc bay	18'7" x 11'3"	5.69 x 3.43
Kitchen Dining max	20'0" x 16'10"	6.09 x 5.13
Sun Room	10'9" x 8'10"	3.28 x 2.70
Store	5'2" x 3'3"	1.58 x 1.00

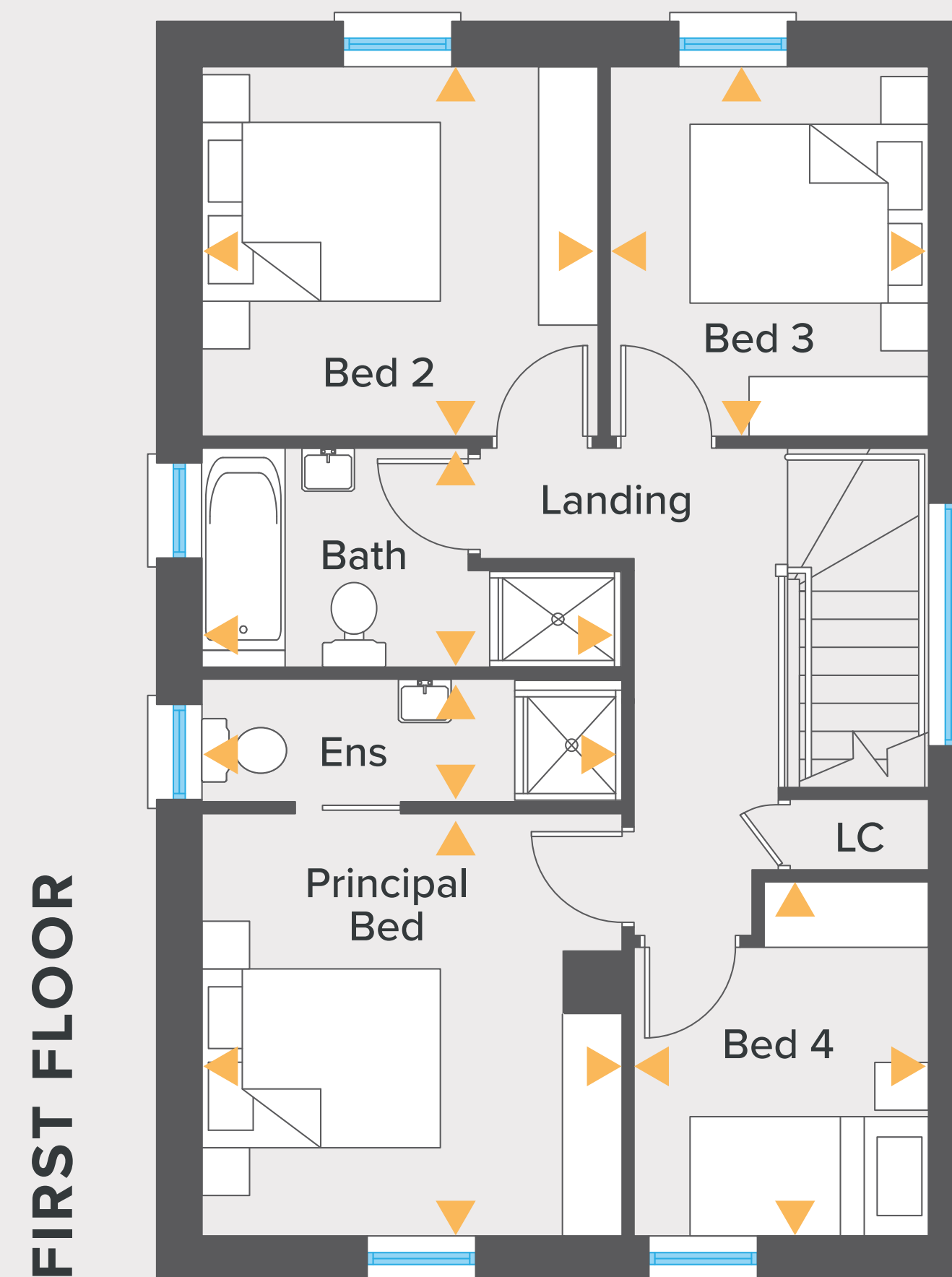

FIRST FLOOR

	Ft/Inch	Metres
Principal Bedroom max	11'8" x 11'7"	3.59 x 3.55
Ensuite	11'7" x 3'3"	3.55 x 0.99
Bedroom 2	10'10" x 10'2"	3.32 x 3.09
Bedroom 3	10'2" x 8'9"	3.09 x 2.67
Bedroom 4	9'10" x 8'2"	2.97 x 2.47
Bathroom max	11'7" x 6'1"	3.55 x 1.85

The Dixon (BH6a) Site nos. 10, 12