

THE BATTEN

SITE NUMBERS - 18-24 & 26-33

Swilly Green
PORTSTEWART



THE BATTEN

SITE NUMBERS - 18-24 & 26-33

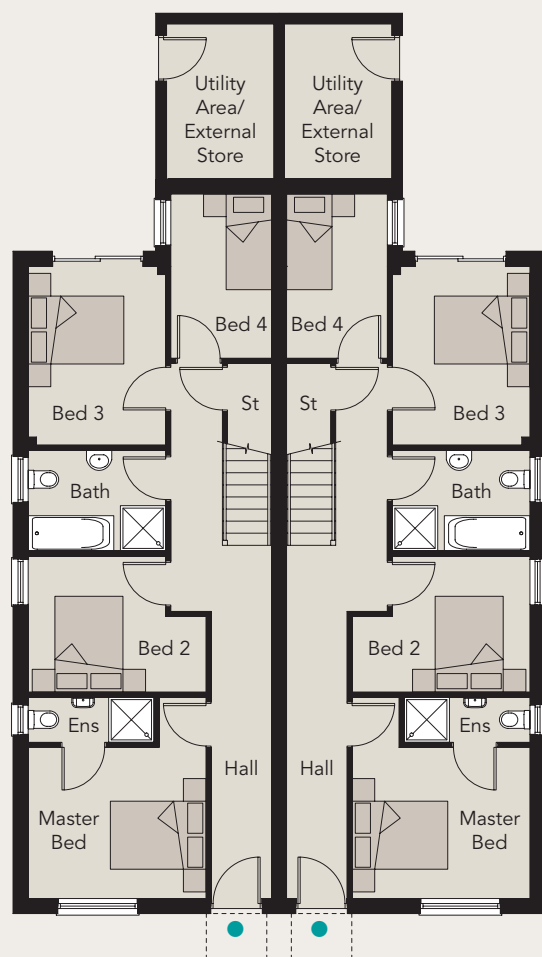

Ground Floor

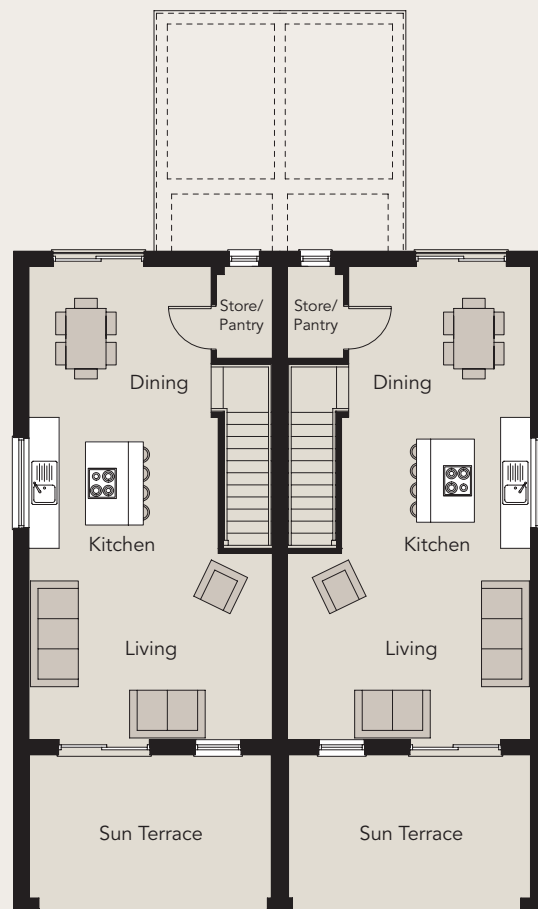

First Floor

Ground Floor

ENTRANCE HALL	
MASTER BEDROOM	11'7" x 9'10"
ENSUITE	8'2" x 2'11"
BEDROOM 2 <i>max</i>	11'7" x 8'10"
BEDROOM 3	11'8" x 9'0"
BEDROOM 4	10'8" x 6'7"
BATHROOM	9'10" x 6'7"
UTILITY AREA / EXTERNAL STORAGE	

First Floor

LIVING	15'10" x 12'2"
SUN TERRACE	15'10" x 9'4"
KITCHEN	12'4" x 8'6"
DINING	11'10" x 9'6"
STORE / PANTRY	6'0" x 3'8"

TOTAL FLOOR AREA 1400 sq ft approx.

Which includes Utility Area / External Store 70 sq ft approx. and Balcony 157 sq ft approx.

All dimensions are approximate and 3D computer generated images are for illustration purposes only, both of which may be subject to change.



COMPUTER VISUAL