

28 Minnowburn Mews, Belfast, BT8 8ST

Price: Offers Over £135,000





McGuinness |
Fleck

Immaculately Presented Apartment Living In South Belfast

Price: £135,000

2 | 2 | 1

This immaculately presented ground floor apartment is located in a popular residential apartment block in the Shaws Bridge area of South Belfast.

The property is located in a quiet yet convenient location with Lagan Towpath, Barnetts Demesne and Belvoir Forest Park on your doorstep and easy access into Belfast city centre, Lisburn and the wider motorway network.

With nothing for buyers to do this apartment comprises bright and spacious living accommodation with light filled lounge with french doors opening onto quiet communal gardens, separate kitchen with large dining space, two well proportioned bedrooms (master with ensuite) and beautiful bathroom. With gas fired central heating and double glazing this property is perfect for first time buyers and down sizers wishing to benefit from the pleasant surroundings and lifestyle.

There has been superb attention to detail with all renovations and with one allocated parking space we highly recommend immediate viewing.

- Ground Floor Apartment In South Belfast Location
- Spacious Open Plan Light Filled Living with Double Doors to Gardens
- Two Well Proportioned Bedrooms; Master with Ensuite Shower Room
- GFCH
- Double Glazing
- Service Charge- £973.24
- Rates- £869.11 pa



Seamus McFlynn

Email: seamus.mcflynn@mcguinnessfleck.com

Phone: 07872 841317

433 435 Lisburn Road, Belfast, BT9 7EY
(0)28 9068 3020 | info@mcguinnessfleck.com

**McGuinness
Fleck**





McGuinness |
Fleck



McGuinness |
Fleck

28 Minnowburn Mews, Belfast, BT8 8ST

Ground Floor

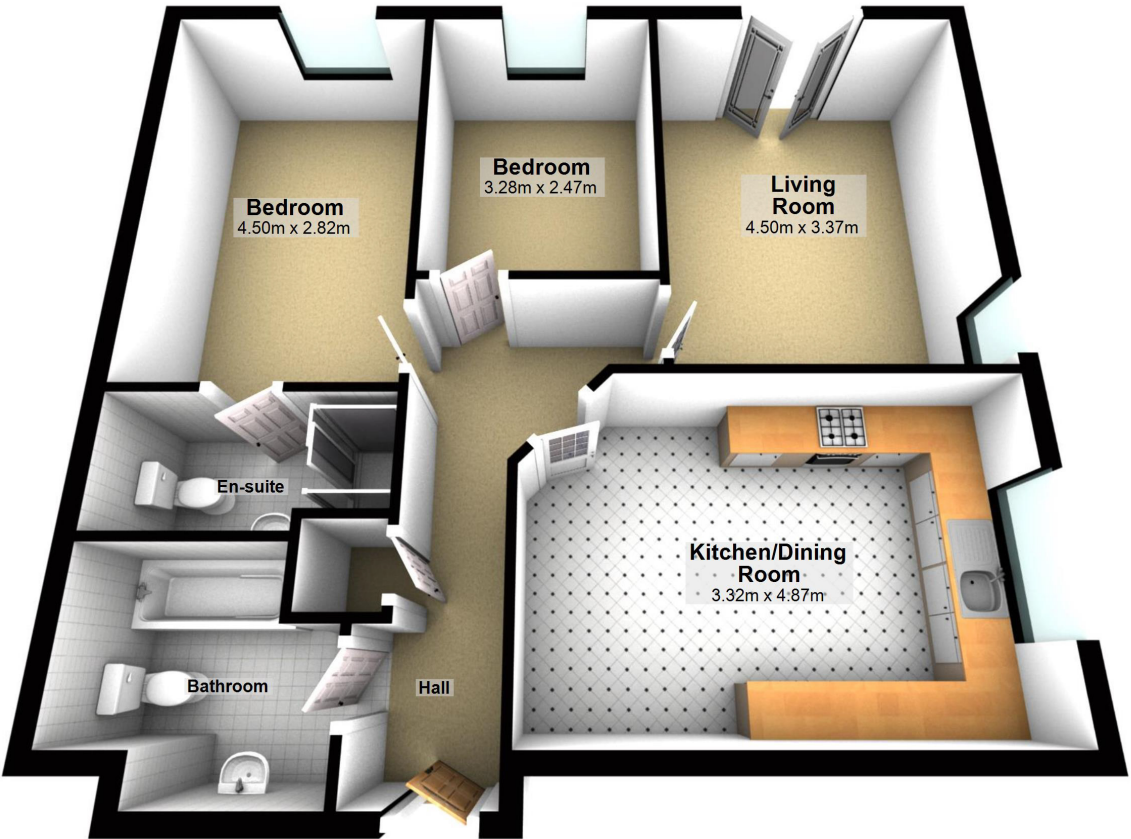

Photography and Floor plans by houseflyni.co.uk #flyonthewallpropertymarketing
Plan produced using PlanUp.

28 Minnowburn Mews, Belfast

	Current	Potential
Very energy efficient - lower running costs		
A 92 plus		
B 81-91		
C 69-80	73	77
D 55-68		
E 39-54		
F 21-38		
G 1-20		
Not energy efficient - higher running costs		

