

2 Storey Block of Apartments;
4No. 2 Person 1 Bedroom 55m²
Apartments, &
12No. 3 Person 2 Bedroom 65m²
Apartments,

10No. 5 Person 3 Bedroom
2 Storey Semi-detached, 95m²
dwellings

12No. 3 Person 2 Bedroom
2 Storey Semi-detached, 75m²
dwellings

New Parish Centre

New covered walkway from Christ
the Redeemer Primary School

	No. Person/ No. Bedroom	Area	No. Units
Type A	5 Person/ 3 Bedroom Semi-detached	95m ²	10
Type B	3 Person/ 2 Bedroom Semi-detached	75m ²	12
Type C	5 Person/ 3 Bedroom (Wheelchair) Detached	134m ²	1
Type D	3 Person/ 2 Bedroom Apartment	65m ²	12
Type E	2 Person/ 1 Bedroom Apartment	55m ²	4
Total Units			39

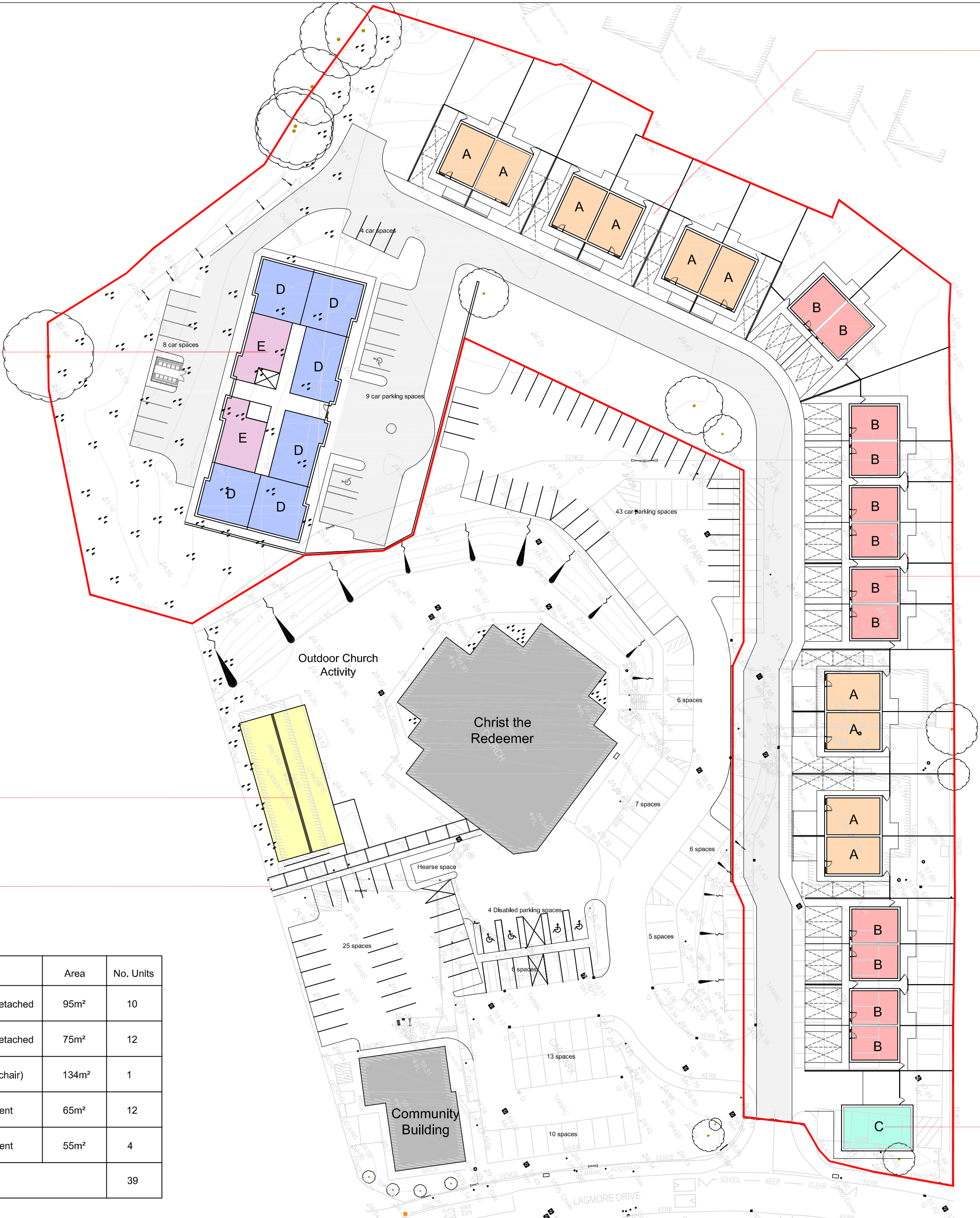

1No. 5 Person 3 Bedroom
2 Storey Detached, Wheelchair
Accessible 134m² dwelling

- NOTES:
1. This drawing is subject to Planning Approval
 2. This drawing is subject to Building Control Approval
 3. This drawing is subject to a specific building and site survey

REV	DESCRIPTION	DATE	INITIALS
-----	-------------	------	----------

PROJECT TITLE
PROPOSED RESIDENTIAL DEVELOPMENT
LAGMORE DRIVE
BELFAST

DRAWING TITLE
PROPOSED SITE PLAN

GMR
Architects Ltd

M: +44(0)77 6846 2808
E: gerry@gmrarchitects.com
W: www.gmrarchitects.com

SCALE	DATE	DRAWN BY
1:500@A2	OCT 20	KK

PROJECT No. 2020-115

DRAWING No.	REVISION
PL-001	A