



**18 Mill Place, The Mill Village, Comber, BT23 5ZL**  
Appealing Semi Detached Villa Of Comparatively Recent Construction - £214,950



# 18 Mill Place, The Mill Village, Comber

## Appealing Semi Detached Villa - £214,950

Built approximately only four years ago by Dunlop Homes, this modern spacious semi offers an up-to-date specification and practical easily managed layout.

It is set in a quiet cul-de-sac position in the highly acclaimed Mill Village development and enjoys the prestige associated with one of Comber's premier addresses.

## Key Features

- Appealing Semi Detached Villa Of Comparatively Recent Construction In The Exclusive Mill Village Development
- Modern Layout Of Accommodation Offering Lounge And Luxury Kitchen Open Plan To Dining Area
- Three Bedrooms Including Master With Deluxe Shower Room Ensuite
- Deluxe Family Bathroom With White Suite Plus Ground Floor Cloakroom Suite
- Gas Fired Central Heating
- Double Glazed Windows
- Tarmac Parking For Two Cars

We endeavour to make our sales details accurate and reliable, however they should not be relied on as statements or representations of fact and they do not constitute any part of an offer or contract. The reseller does not make any representation or give any warranty in relation to the property and we have no authority to do so on behalf of the seller. Any information given by us in these sales details or otherwise is given without responsibility on our part. Services, fitting, and equipment referred to in the sales details have not been tested (unless otherwise stated) and no warranty can be given as to their condition. We strongly recommend that all information, which we provide, about the property is verified by yourself or your advisers. Site plans on brochures are not drawn to scale, however we are happy to provide scale drawings from our office. Artist's impressions are for illustrative purposes only. All details including materials, finishes etc. should be clarified with the agents prior to booking.

## Floor Plans

### Ground Floor

Approx. 47.7 sq. metres (513.5 sq. feet)

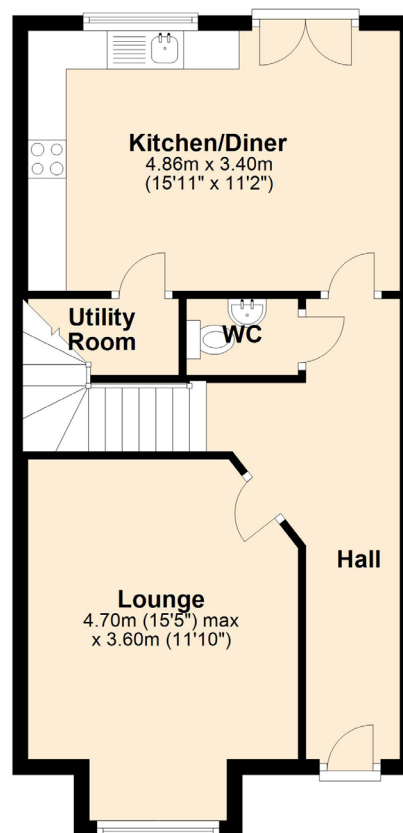

### First Floor

Approx. 48.0 sq. metres (517.2 sq. feet)

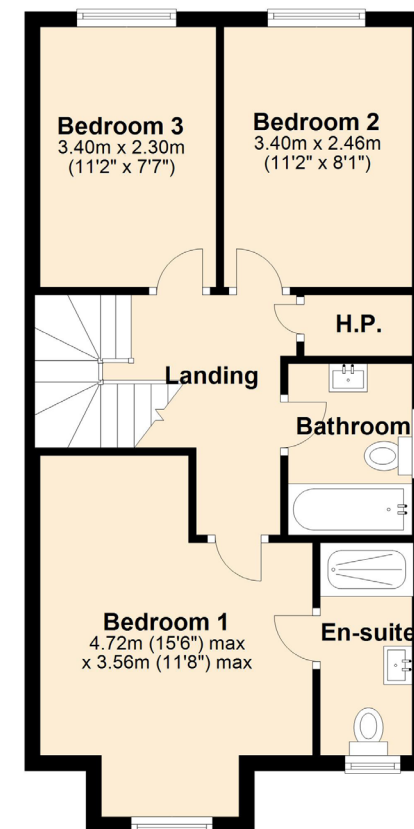

Total area: approx. 95.8 sq. metres (1030.7 sq. feet)









# 18 Mill Place, The Mill Village, Comber

## Appealing Semi Detached Villa - £214,950

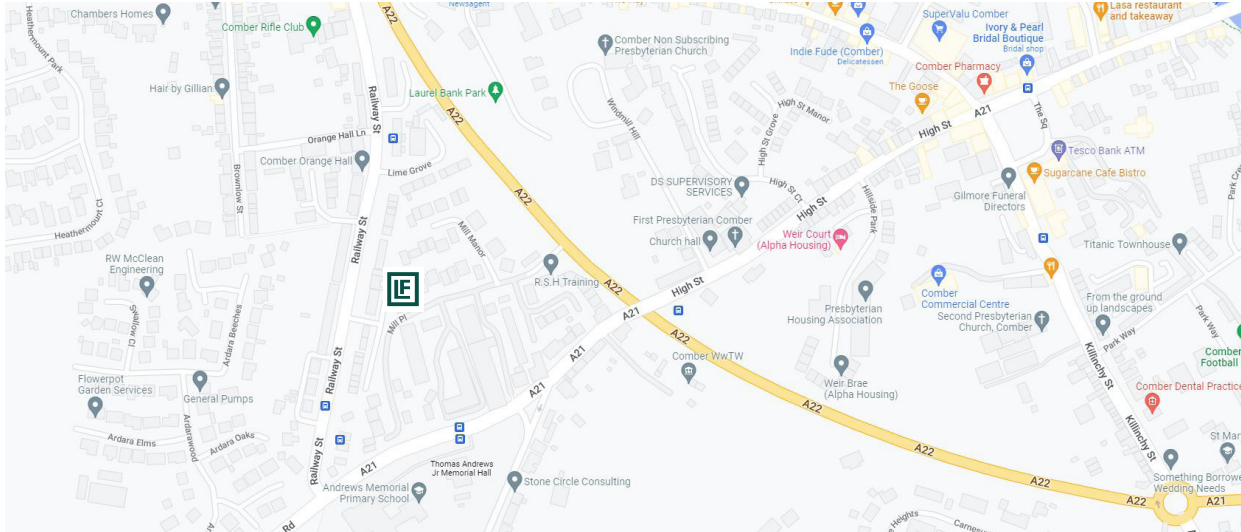

Score	Energy rating	Current	Potential
92+	A		
81-91	B	83   B	83   B
69-80	C		
55-68	D		
39-54	E		
21-38	F		
1-20	G		

### Office Information

Comber office  
2 The Square, Comber, BT23 5DT  
**028 9187 1787**  
[comber@lindsayfyfe.co.uk](mailto:comber@lindsayfyfe.co.uk)

