



26 Todds Hill Park, Saintfield, BT24 7FB
Spacious Townhouse in a Small Exclusive Development - £169,950



26 Todds Hill Park Saintfield, BT24 7FB

Spacious Townhouse in a Small Development - £169,950

Situated in a quiet cul-de-sac position within walking distance of Saintfield town and its many amenities, this attractive modern home enjoys convenience in a semi rural environment. The well proportioned accommodation is beautifully presented throughout with an up to date specification and offers an interesting layout with appealing features.

Key Features

- Spacious Townhouse in a Small Exclusive Development
- Luxury Kitchen/Dining Room with Built in Appliances & French Doors to Gardens
- Three Bedrooms Including Master with Shower Room Ensuite
- Large Family Sized Lounge with Pleasant Outlook
- Oil Fired Central Heating
- Double Glazed Windows in PVC Frames
- PVC External Joinery for Ease of Management
- Integral Garage with Utility Area to Rear

We endeavour to make our sales details accurate and reliable, however they should not be relied on as statements or representations of fact and they do not constitute any part of an offer or contract. The reseller does not make any representation or give any warranty in relation to the property and we have no authority to do so on behalf of the seller. Any information given by us in these sales details or otherwise is given without responsibility on our part. Services, fitting, and equipment referred to in the sales details have not been tested (unless otherwise stated) and no warranty can be given as to their condition. We strongly recommend that all information, which we provide, about the property is verified by yourself or your advisers. Site plans on brochures are not drawn to scale, however we are happy to provide scale drawings from our office. Artist's impressions are for illustrative purposes only. All details including materials, finishes etc. should be clarified with the agents prior to booking.

Floor Plans

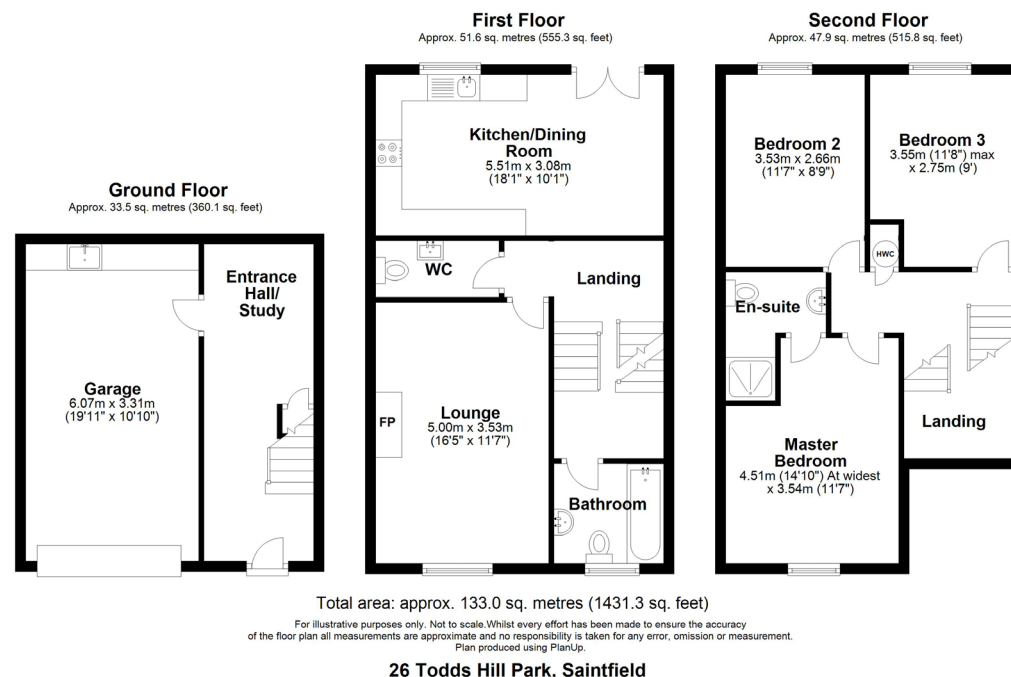





26 Todds Hill Park Saintfield, BT24 7FB

Spacious Townhouse in a Small Development - £169,950

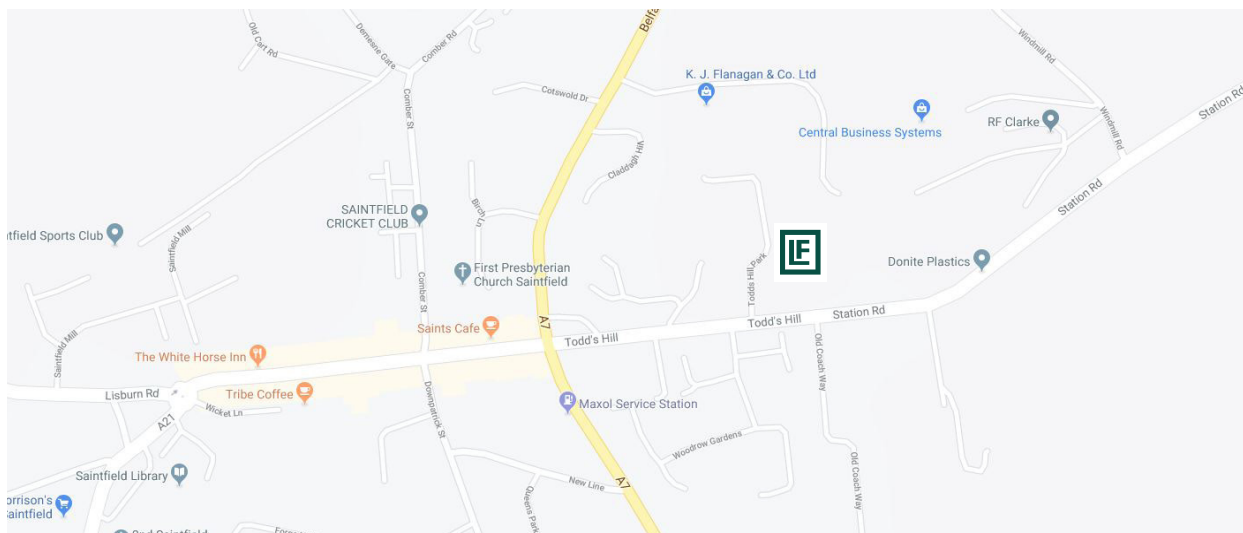

Energy Efficiency Rating		
	Current	Potential
Very energy efficient • lower running costs		
A 92 plus		
B 81-91		
C 69-80		
D 55-68		
E 39-54	50	58
F 21-38		
G 1-20		
Not energy efficient • higher running costs		

Office Information

Comber office

2 The Square, Comber, BT23 5DT

028 9187 1787

comber@lindsayfyfe.co.uk

