

5 Rossenara Court, Comber, BT23 5GX
Extended Modern Townhouse in a Small Mews Style Development - £195,000



5 Rossenara Court, Comber, BT23 5GX

Extended Townhouse in a Small Development - £195,000

One of only five luxury townhouses in an exclusive mature cul-de-sac on the Belfast side of town, Of comparatively recent construction, the property offers a modern well planned and easily managed layout which has been enhanced by the provision of a spacious second reception room, suitable perhaps as a ground floor fourth bedroom, if required.

Key Features

- Extended Modern Townhouse in a Small Mews Style Development
- Beautifully Proportioned Lounge with Open Fire and Separate Spacious Dining Room
- Luxury Recently Installed Kitchen with Built in Appliances and Breakfast Area
- Three Bedrooms Including Master With Shower Room Ensuite and Feature Juliette Balcony
- Bathroom with White Suite
- Gas Fired Central Heating
- Double Glazed Windows
- Driveway Plus Two Additional Car Parking Spaces

We endeavour to make our sales details accurate and reliable, however they should not be relied on as statements or representations of fact and they do not constitute any part of an offer or contract. The reseller does not make any representation or give any warranty in relation to the property and we have no authority to do so on behalf of the seller. Any information given by us in these sales details or otherwise is given without responsibility on our part. Services, fitting, and equipment referred to in the sales details have not been tested (unless otherwise stated) and no warranty can be given as to their condition. We strongly recommend that all information, which we provide, about the property is verified by yourself or your advisers. Site plans on brochures are not drawn to scale, however we are happy to provide scale drawings from our office. Artist's impressions are for illustrative purposes only. All details including materials, finishes etc. should be clarified with the agents prior to booking.

Floor Plans

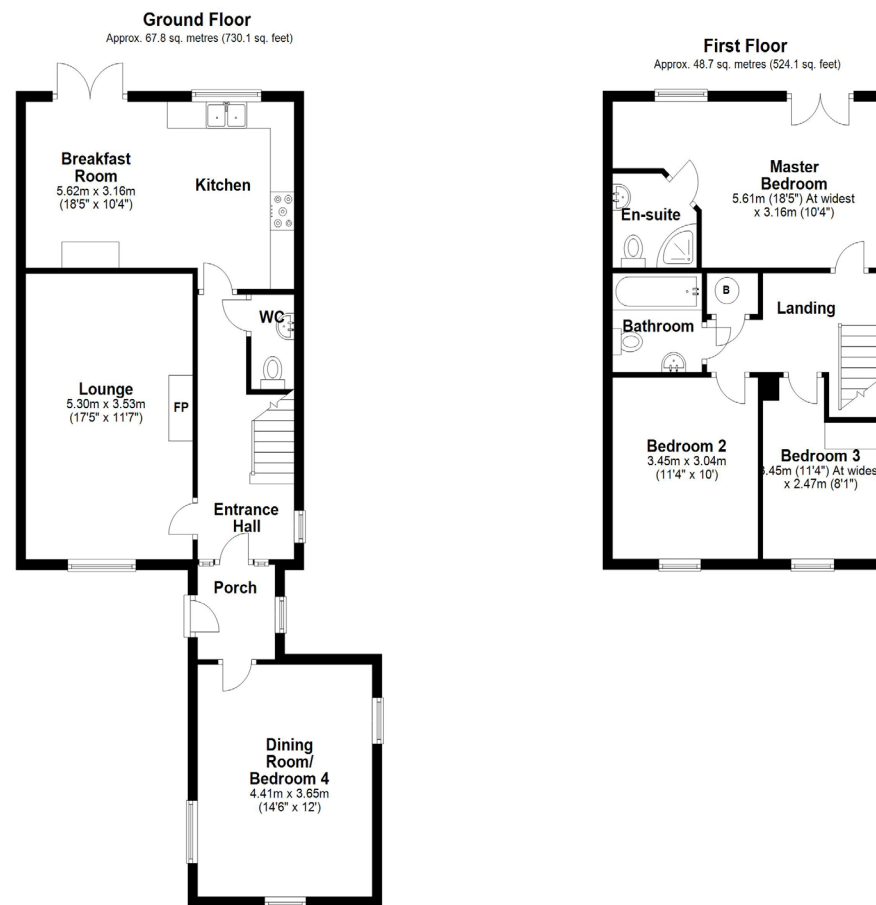

Total area: approx. 116.5 sq. metres (1254.2 sq. feet)

For illustrative purposes only. Not to scale. Whilst every effort has been made to ensure the accuracy of the floor plan all measurements are approximate and no responsibility is taken for any error, omission or measurement. Plan produced using PlanUp.

5 Rossenara Court, Comber





5 Rossenara Court, Comber, BT23 5GX

Extended Townhouse in a Small Development - £195,000

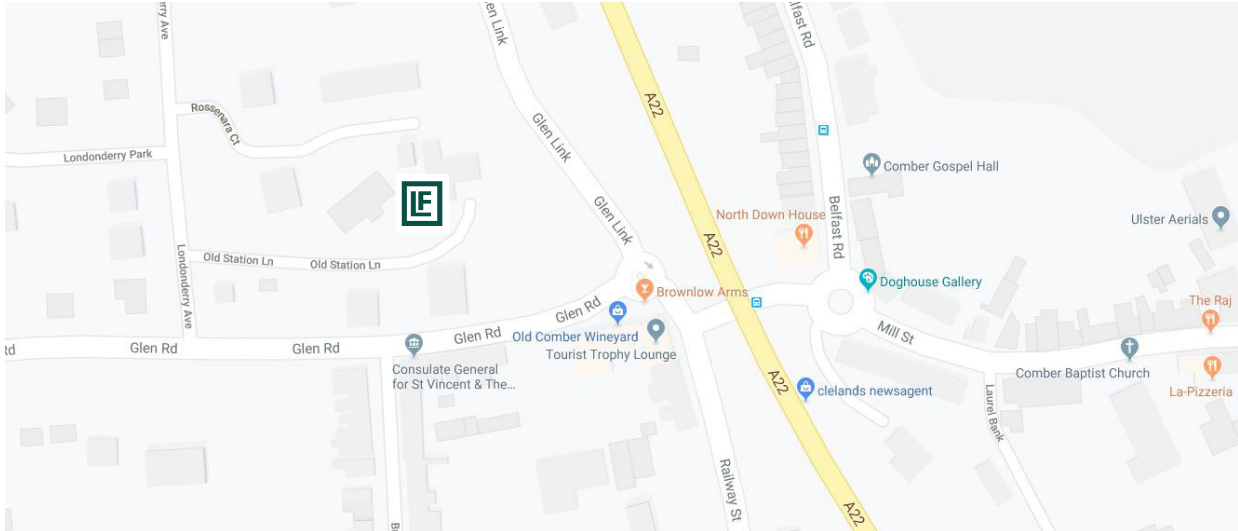

Energy Efficiency Rating		
	Current	Potential
Very energy efficient - lower running costs		
A 92 plus		
B 81-91		
C 69-80		
D 55-68	67	69
E 39-54		
F 21-38		
G 1-20		
Not energy efficient - higher running costs		

Office Information

Comber office

2 The Square, Comber, BT23 5DT

028 9187 1787

comber@lindsayfyfe.co.uk

