



## J. A. McClelland & Sons

Estate Agents • Auctioneers • Valuers • Rural & Land Agents

### FOR SALE MILLBANK ROAD & MILLBANK ROAD EAST TEMPLEPATRICK



#### APPROVED BUILDING SITE, MODERN FARM BUILDING & c. 11 ACRES OF AGRICULTURAL LAND IN A PRIME LOCATION ADJACENT TO THE DEVELOPMENT LIMIT (AVAILABLE IN ONE OR MORE LOTS)

The property occupies an excellent location approx 3 miles from Sandyknowes and 2 ½ miles from Templepatrick and can be offered as follows: -

**LOT 1** - An attractive building site on approx. ½ acre bounded by the Ballymartin Burn and with frontage to the Millbank Road. **O.I.R.O. £120,000** (N.B. Access to the site is off the driveway coloured yellow)

**LOT 2** - A small grazing paddock of approx. 0.46 acre separated from Lot 1 by the Ballymartin Burn. This could be sold with lot 1. **O.I.R.O. £10,000**

**LOT 3** - A modern farm building 45' x 40' with c. 1.65 acres of land immediately adjacent to the current development limit with excellent potential for future development. This lot includes ownership of the driveway coloured yellow. **O.I.R.O. £75,000**

**LOT 4** - A field of good quality land comprising c. 8.77 acres and with frontage to the Millbank Road East. **O.I.R.O. £150,000**

**VIEWING: - Anytime**

[www.jamcclelland.com](http://www.jamcclelland.com)

MAP FOR IDENTIFICATION PURPOSES ONLY. NOT TO SCALE.

Reproduced from the Ordnance Survey Map with  
the sanction of the Controller of H.M. Stationery  
Office, Crown Copyright reserved.

J. A. McCLELLAND & SONS (Aucts.) LTD

These plans are given for information purposes only  
on the understanding that they will not be construed as  
part of any contract, conveyance or Lease. Whilst every  
care is taken in this preparation, J. A. McClelland & Sons  
(Aucts.) Ltd., and their staff cannot give any guarantee  
as to their accuracy.

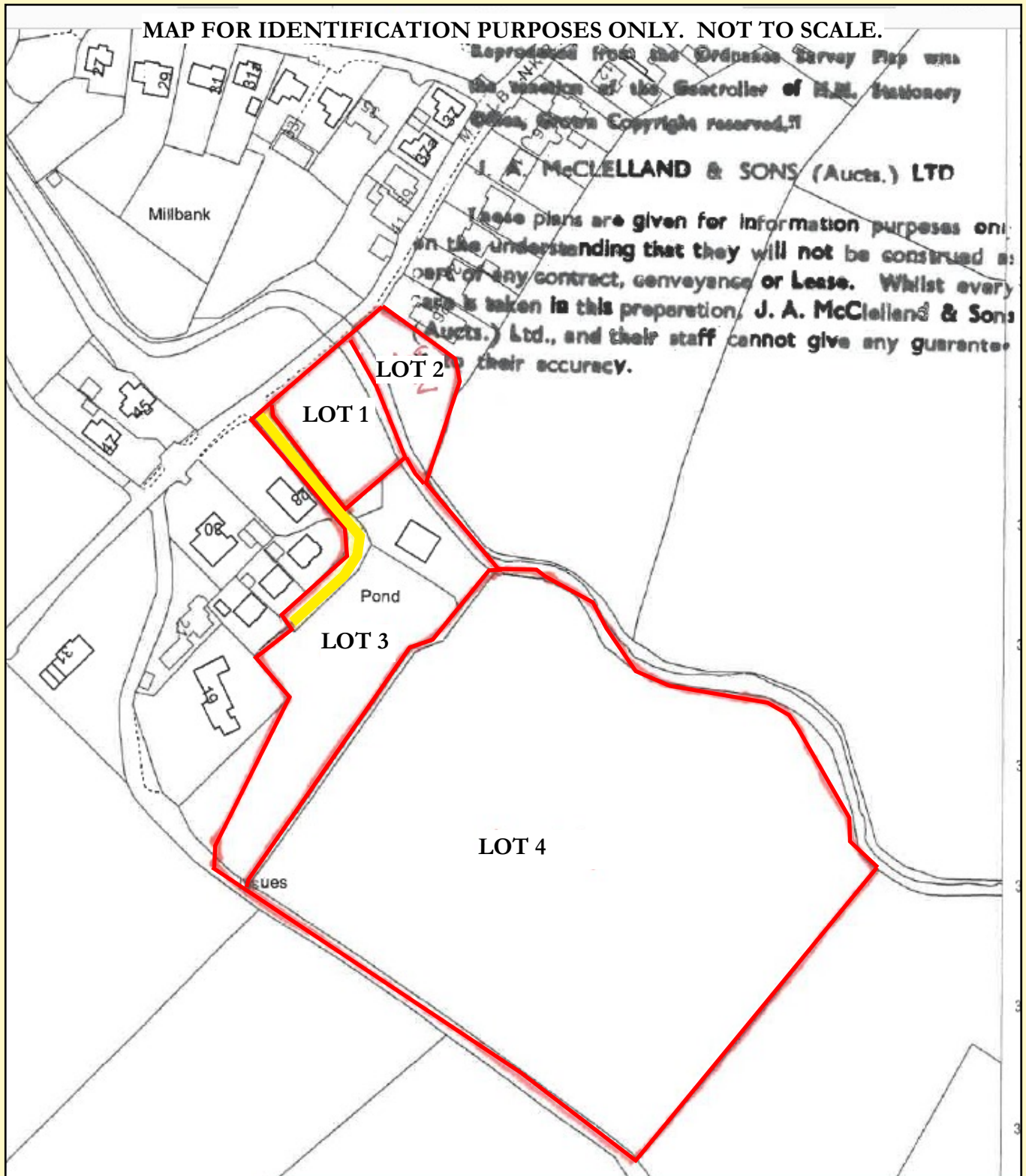

Joint Agent: - Country Estates (Glengormley)

Tel: - 028 9083 0803



**J. A. McClelland & Sons**

Estate Agents • Auctioneers • Valuers • Rural & Land Agents

2 Doagh Road, Ballyclare, BT39 9BH

Tel: 028 9335 2727 Fax: 028 9334 2447

Email: sales@jamcclelland.com

[www.jamcclelland.com](http://www.jamcclelland.com)

#### AGENT'S NOTES

J A McClelland & Sons Ltd and their clients give notice that:

1. They have no authority to make or give any representations or warranties in relation to the property.
2. These particulars have been prepared in good faith to give an overall view of the property, they do not form any part of an offer or contract, and must not be relied upon as statements of representations of fact.
3. Any areas, measurements or distances are approximate. The text, photographs and plans are for guidance only and are not necessarily comprehensive. It should not be assumed that the property has all necessary planning, building regulation or other consents and J A McClelland & Sons Ltd have not tested any services, equipment or facilities. Purchasers must satisfy themselves by inspection or otherwise.