

# THE BROMPTON

HW04 - BRICK



*Computer visual.*



## HELENS WOOD

RATHGAEL ROAD ~ BANGOR



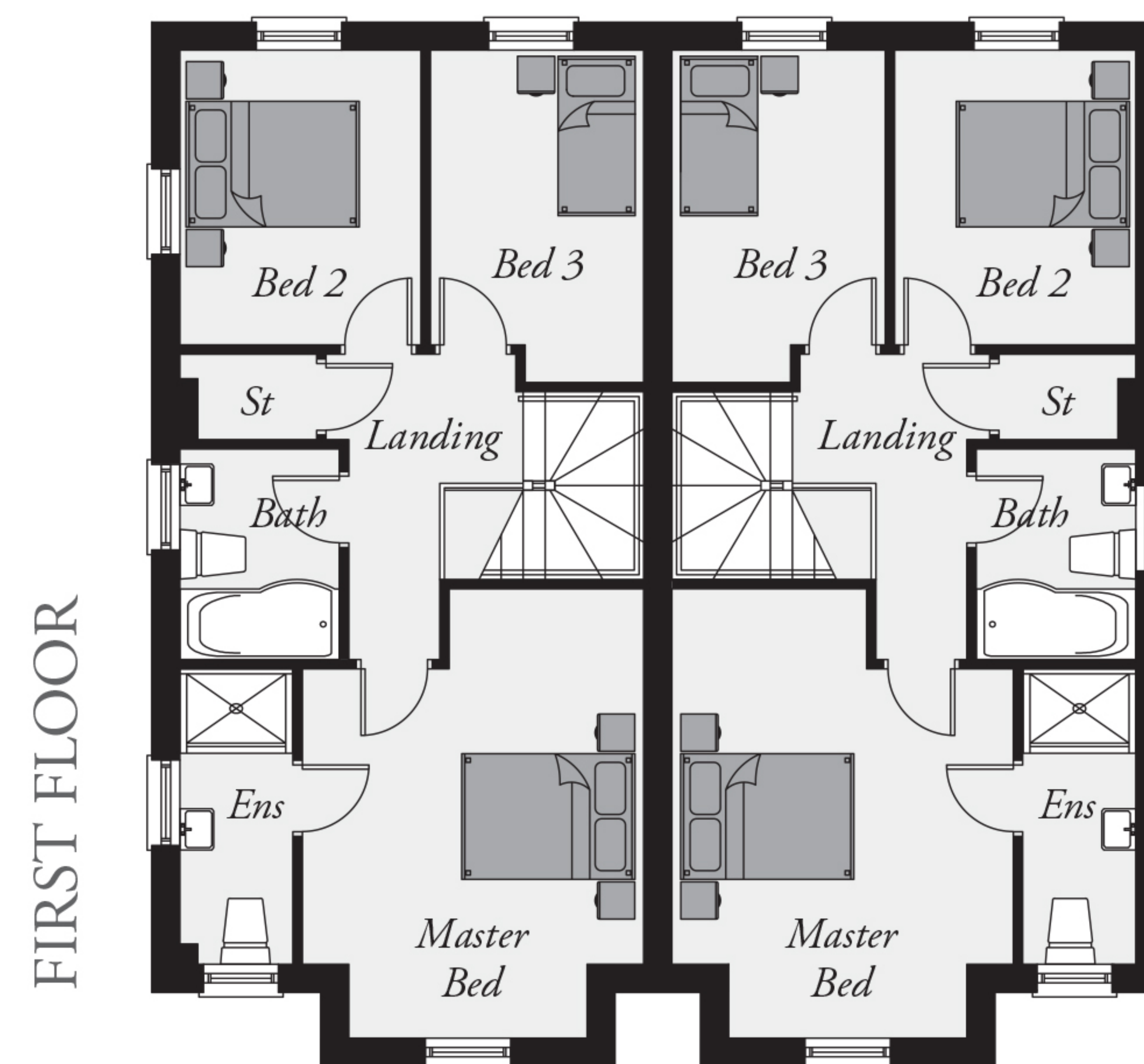
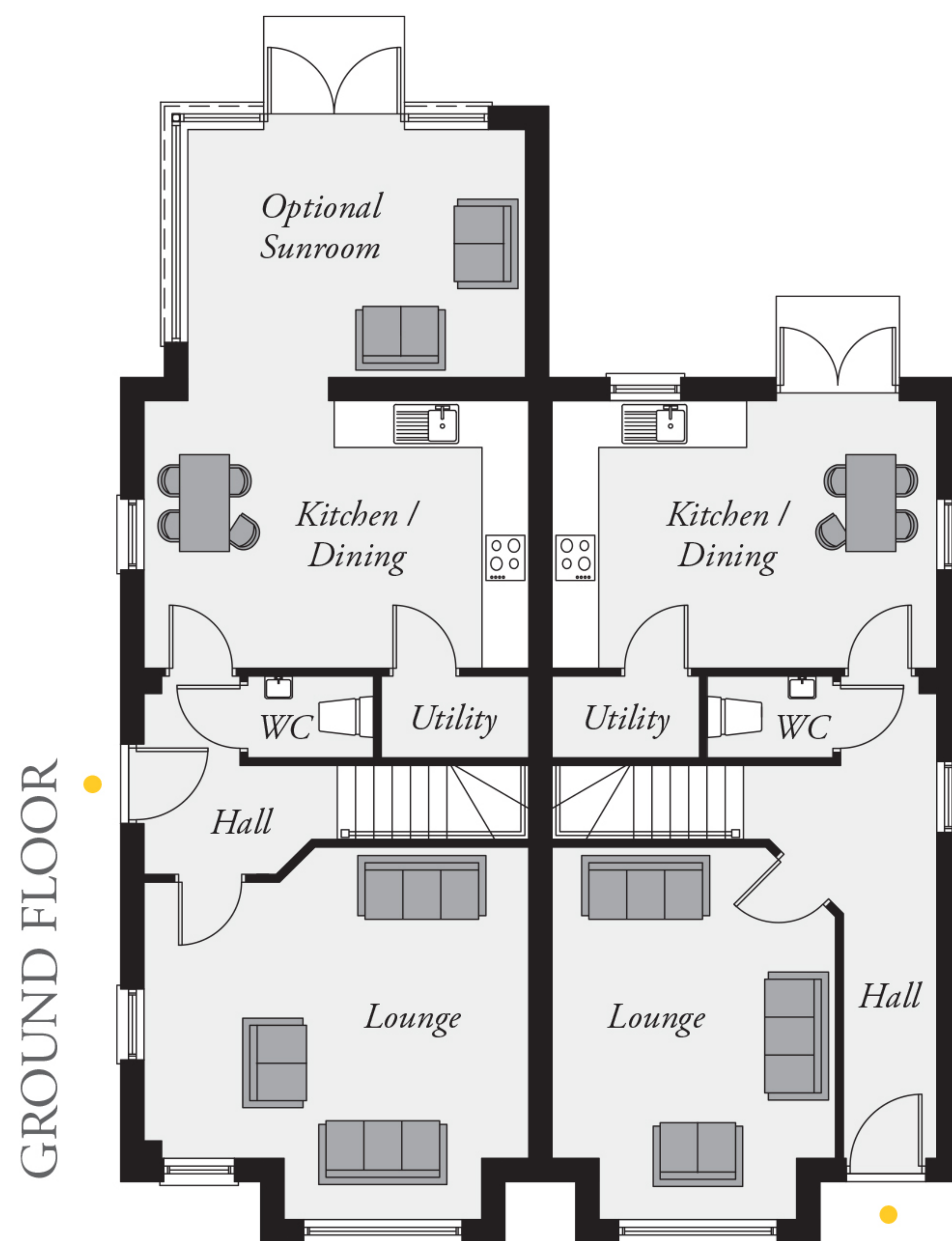

## GROUND FLOOR

Entrance Hall (with separate WC)	
Lounge (side entrance property)	16'2" x 15'8" (max inc bay)
Lounge (front entrance property)	15'8" x 11'11" (max inc bay)
Kitchen / Dining	16'2" x 11'3"
Utility Room	6'2" x 3'5"
Optional Sunroom	14'2" x 10'5"

## FIRST FLOOR

Master Bedroom	15'8" x 11'11" (max inc bay)
Ensuite	
Bedroom 2	10'3" x 8'5"
Bedroom 3	11'7" x 7'5"
Bathroom	

## TOTAL FLOOR AREA

1,063 sq. ft. approx.  
(With optional sunroom 1,212 sq. ft. approx.)



Telephone 028 9146 3721  
[www.reedsrains.co.uk](http://www.reedsrains.co.uk)



NEW HOMES

Telephone 028 9024 4000  
[www.colliersni.com](http://www.colliersni.com)



[www.laganhomes.com](http://www.laganhomes.com)