

12 Clandeboy Road, Bangor,
County Down, BT20 3LA

Asking Price: £122,500

 **Reeds Rains**

[reedsrains.co.uk](https://www.reedsrains.co.uk)

12 Clandeboye Road, Bangor, County Down, BT20 3LA
Asking Price: £122,500

EPC Rating: TBC

Description

This two-bedroom semi-detached villa enjoys a convenient location on Clandeboye Road in Bangor, offering well-laid-out accommodation ideal for a range of buyers. Whether you're a first-time buyer, downsizer, or investor, this home provides comfortable living with scope to personalise.

With a bright lounge, separate dining area, fitted kitchen, and white bathroom suite, the layout is practical and welcoming. Two well-sized bedrooms on the first floor provide ample sleeping space, while the enclosed rear garden adds a touch of privacy and outdoor enjoyment.

Entrance Hall

uPVC double glazed front door, laminate wooden floor.

Lounge

12'6" x 11'2" (3.8m x 3.4m)
Laminate wooden floor, feature wooden fireplace with tiled inset and hearth.

Kitchen / Dining

15'1" x 11'7" (4.6m x 3.53m)
Single drainer 1.5 stainless steel sink unit with mixer taps, excellent range of part tiled walls, laminate wooden floor, built in oven and 4 ring ceramic hob, stainless steel splashback, stainless steel chimney extractor fan, plumbed for washing machine, integrated dishwasher, integrated fridge freezer,. Open plan to casual dining area, uPVC double glazed door to rear garden.

First Floor Landing

Access to roof space.

Bedroom 1

12'3" x 9'11" (3.73m x 3.02m)
Laminate wooden floor, double built in robe.

Bedroom 2

9'10" x 8' (3m x 2.44m)
Laminate wooden floor.

Bathroom

White suite comprising: Panelled bath with electric shower, low flush WC, pedestal wash hand basin, fully tiled walls, extractor fan. Airing cupboard with Gas boiler.

Outside

2 x off street car parking spaces to the front of the property.

Gardens

Generous enclosed rear garden in lawns and paved patio area. Garden shed. Outside tap and light. Garden store and external power points.

NB

CUSTOMER DUE DILIGENCE As a business carrying out estate agency work, we are required to verify the identity of both the vendor and the purchaser as outlined in the following: The Money Laundering, Terrorist Financing and Transfer of Funds (Information on the Payer) Regulations 2017 - <https://www.legislation.gov.uk/ukxi/2017/692/c> ontents

To be able to purchase a property in the United Kingdom all agents have a legal requirement to conduct Identity checks on all customers involved in the transaction to fulfil their obligations under Anti Money Laundering regulations. We outsource this check to a third party and a charge will apply of £20 + Vat for each person.

The Reeds Rains branches at 350 Upper Newtownards Road, Ballyhackamore, Belfast, N Ireland BT4 3EX, 18 Main Street, Bangor, Co Down, N Ireland BT20 5AG, Somerset House, 240-242 Ormeau Road, Belfast, Co Antrim, N Ireland BT7 2FZ, 10 High Street, Carrickfergus, Co Antrim, N Ireland BT38 7AF, 8/8A Carrmoney Road, Glengormley, County Antrim, N Ireland BT36 6HN, 14/16 Market Street, Lisburn, County Antrim , N Ireland BT28 1AB and 2 Frances Street, Newtownards, County Down, N Ireland BT23 4JA are operated by Favsko NI Limited which is independently owned and operated under a Licence from Reeds Rains Limited.

All Measurements
All Measurements are Approximate.

Laser Tape Clause
All measurements have been taken using a laser tape measure and therefore, may be subject to a small margin of error.

Floorplan Clause
Measurements are approximate. Not to Scale. For illustrative purposes only.

For full EPC please contact the branch.

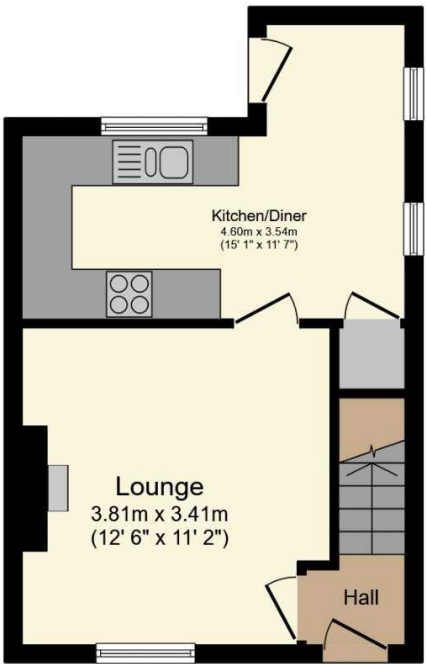

Ground Floor

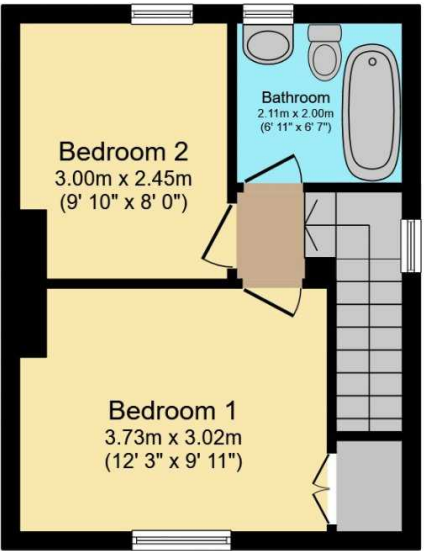

First Floor

Total floor area 58.5 sq.m. (629 sq.ft.) approx

This floor plan is for illustrative purposes only. It is not drawn to scale. Any measurements, floor areas (including any total floor area), openings and orientation are approximate. No details are guaranteed, they cannot be relied upon for any purpose and they do not form part of any agreement. No liability is taken for any error, omission or misstatement. A party must rely upon its own inspection(s).
Powered by www.focalagent.com