



Donegall Avenue,

£84,950



Reeds Rains

• Since 1868 •

www.reedsrains.co.uk



Donegall Avenue, Belfast
£84,950

We are delighted to market this mid terrace property located in a popular and convenient location set between Tates Avenue and Donegall Road. The property offers easy access to the Lisburn Road, City Hospital, Belfast City Centre and much more within close proximity. Trains and bus routes to Belfast City centre and beyond are also on the doorstep. Internally this property offers living room open plan to dining area, kitchen and rear hall to ground floor bathroom. Upstairs boasts two bedrooms. Externally there is a fully enclosed rear yard. Other benefits include fully double glazed windows and gas fired central heating. Sure to attract interest especially with the first time buyer and landlord markets. We fully recommend internal inspection. Viewing is by appointment through Reeds Rains Ormeau Road on 028 9068 0420

PVC FRONT DOOR

ENTRANCE HALL

Laminate hardwood flooring.

LIVING ROOM

3.23m x 2.67m (10'7" x 8'9")
Front aspect. Laminate hardwood flooring. Through to:-

DINING ROOM

3.23m x 2.90m (10'7" x 9'6")
Rear aspect. Laminate hardwood flooring. Under stair storage cupboard. Glazed hardwood door to:-

REAR HALL

Built in storage cupboard.

BATHROOM

2.31m x 1.73m (7'7" x 5'8")
Low flush WC. Panelled bath with mixer taps and over head thermostatically controlled shower. Pedestal wash hand basin with mono tap. Tiled walls. Tiled floor.

FIRST FLOOR LANDING

Access to loft.

BEDROOM 1

3.81m x 3.12m (12'6" x 10'3")
Front aspect.

BEDROOM 2

3.07m x 2.26m (10'1" x 7'5")

Rear aspect.

OUTSIDE

Enclosed rear yard. External storage.

FLOORPLAN



For full EPC please contact the branch

HOUSE TO SELL?

Call our office to arrange a free no obligation sales appraisal.

NEED MORTGAGE ADVICE?

Available in branch.

Laser Tape Clause

All measurements have been taken using a laser tape measure and therefore, may be subject to a small margin of error.

Floorplan Clause

Measurements are approximate. Not to Scale. For illustrative purposes only

Ground Floor

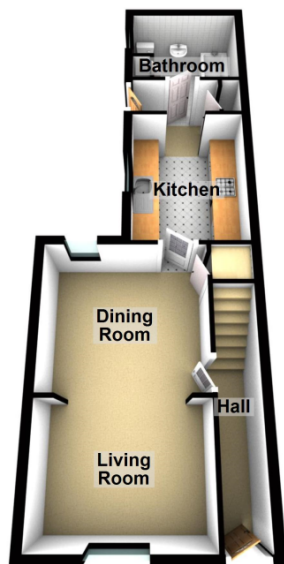

First Floor

